

Revizto Site

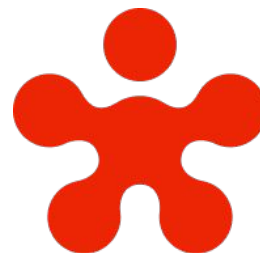

# Install from App Stores

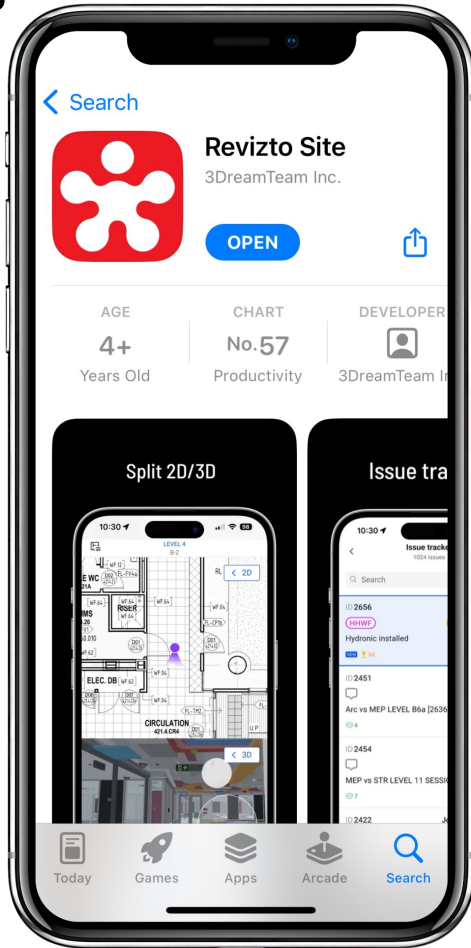
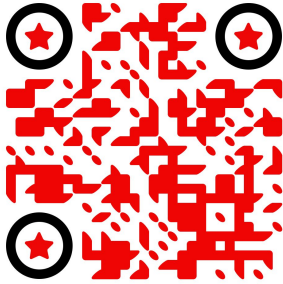

# Open Project / field download

Select project **information**

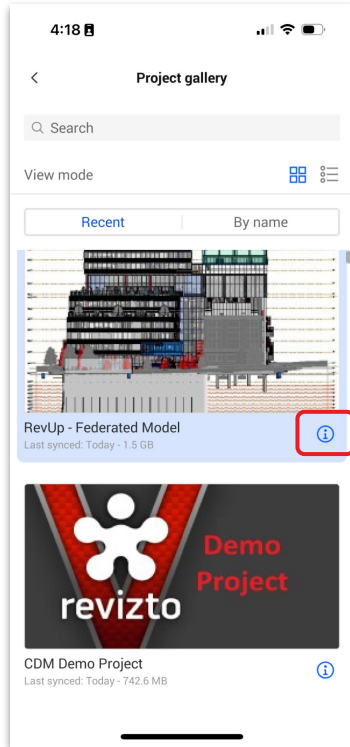

Project **Info.**  
download for **field**

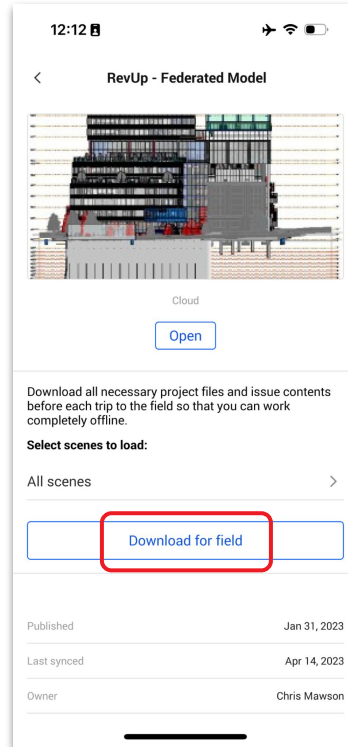

Clear **Cache**

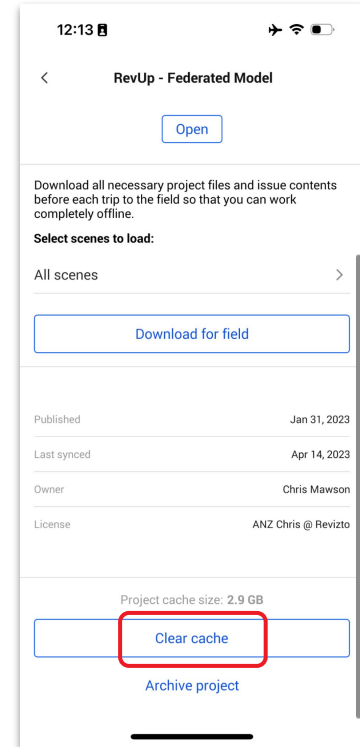

# Open Project / Set Preferences

## Select and open project

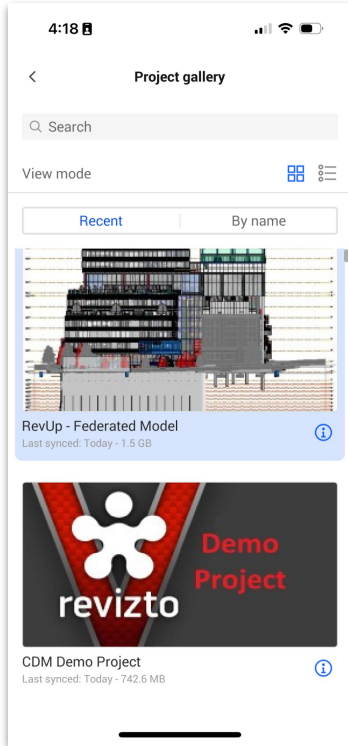

## Open Preferences

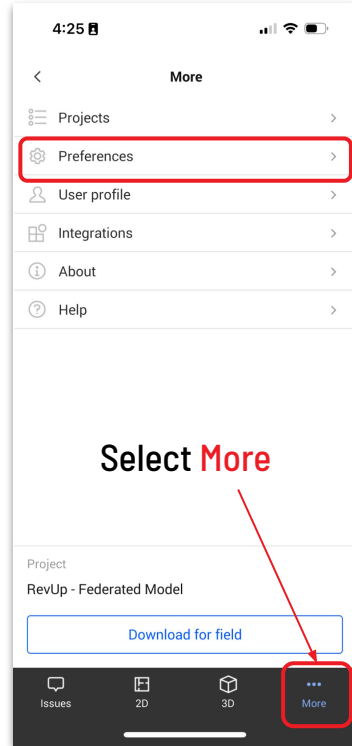

Select More

## Setup preferences

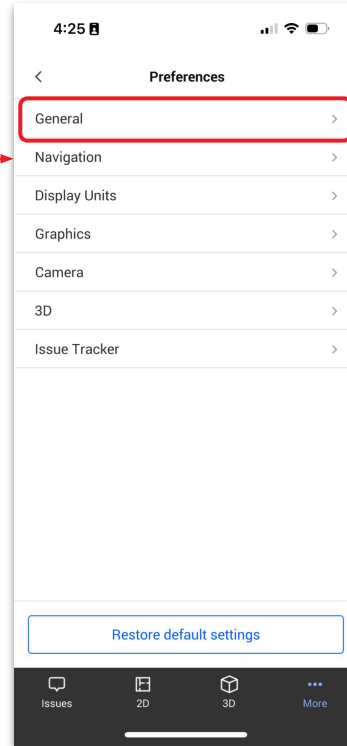

## General Settings

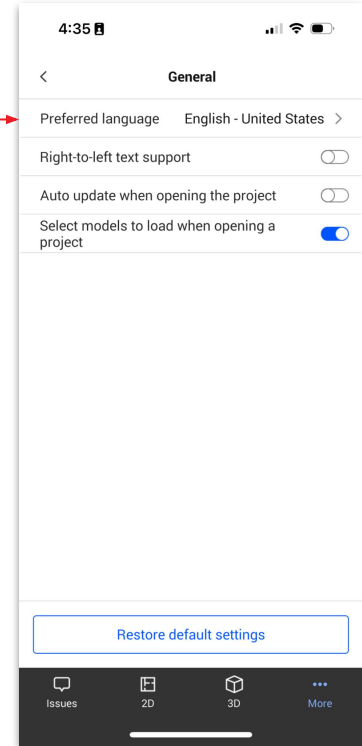

# Set Preferences

## Navigation

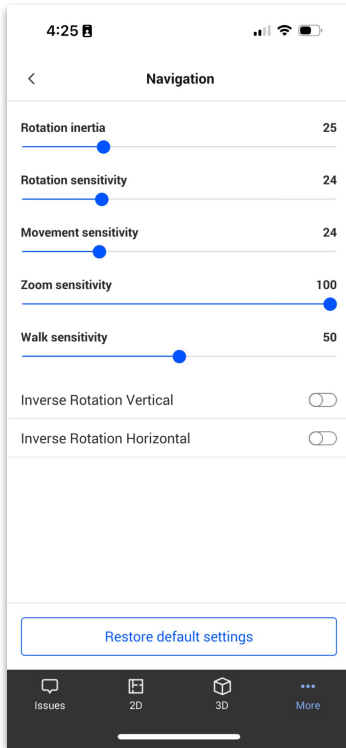

## Units

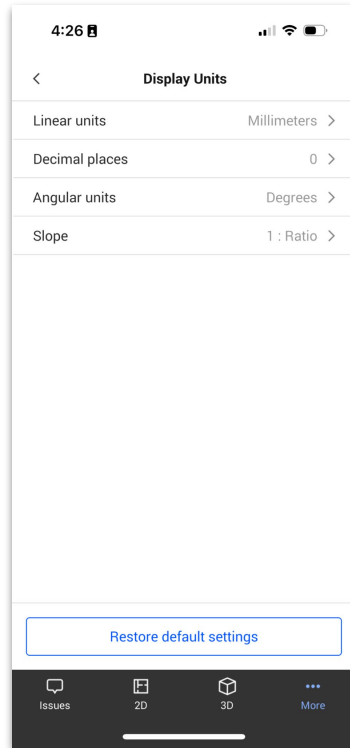

## Graphics

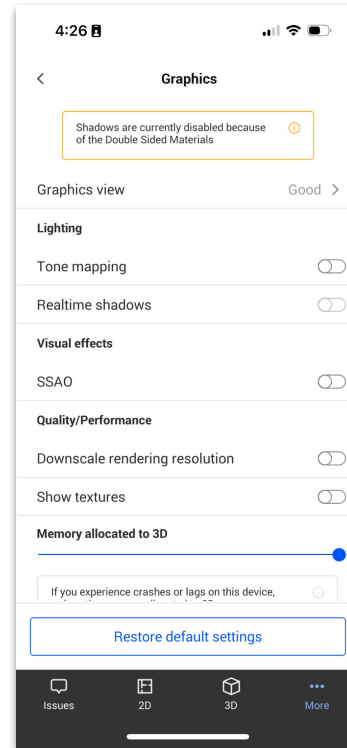

## Camera

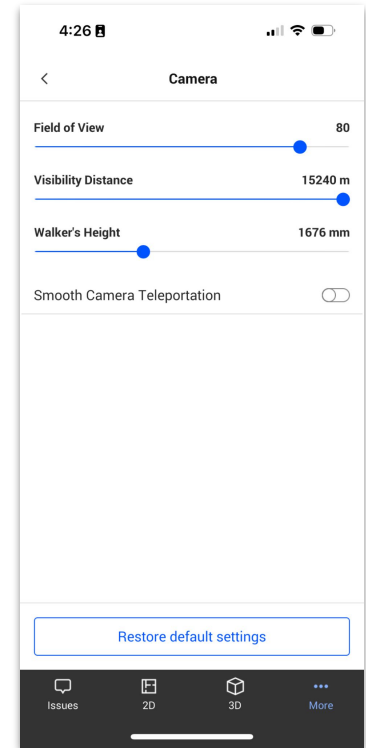

# Set Preferences

## 3D

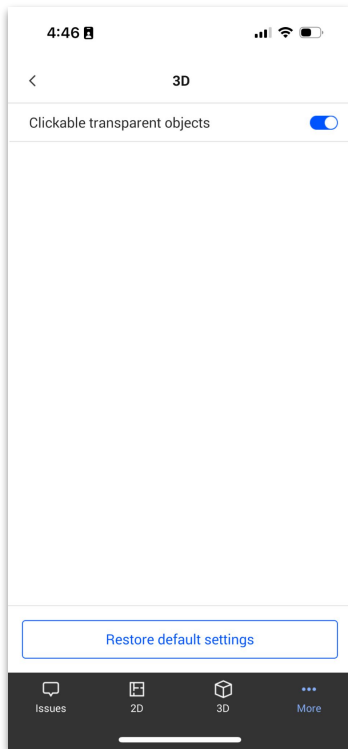

## Issue Tracker

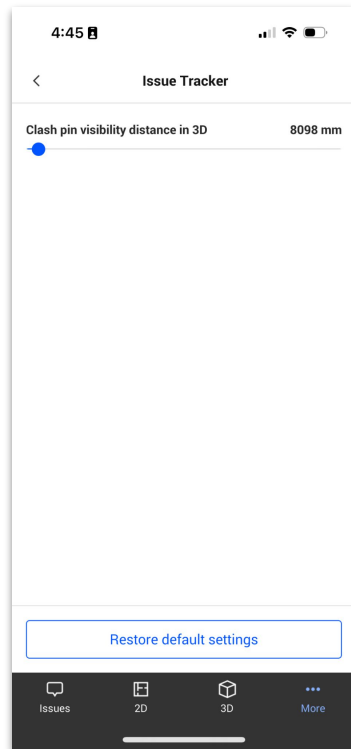

# Download for Field

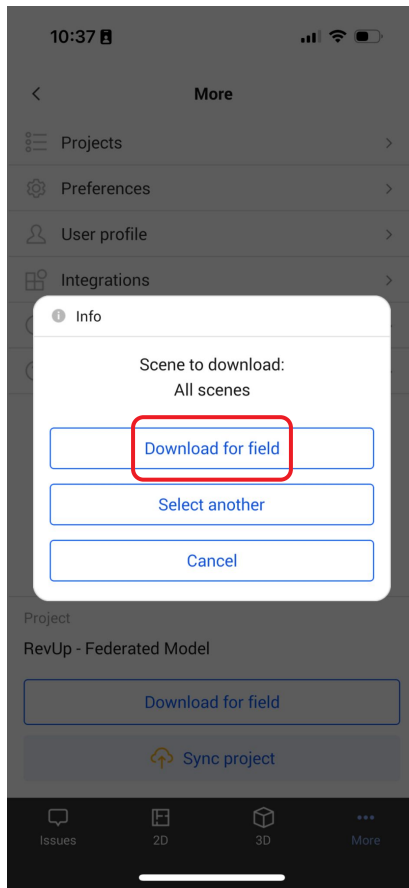
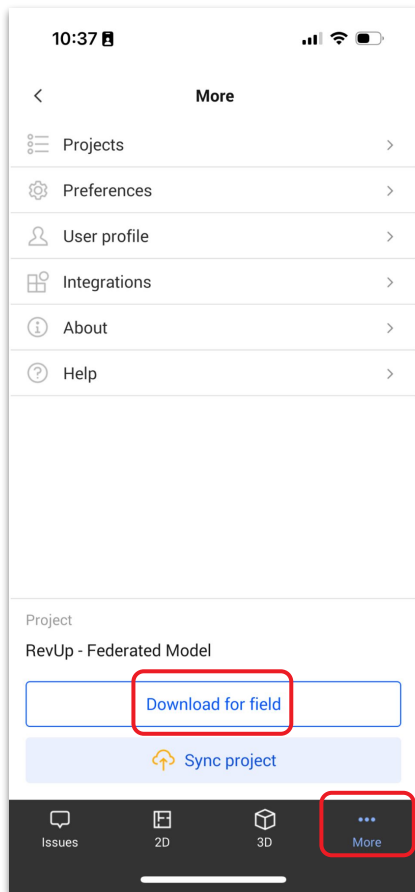

If you have added Custom Properties  
→  
you will need to sync

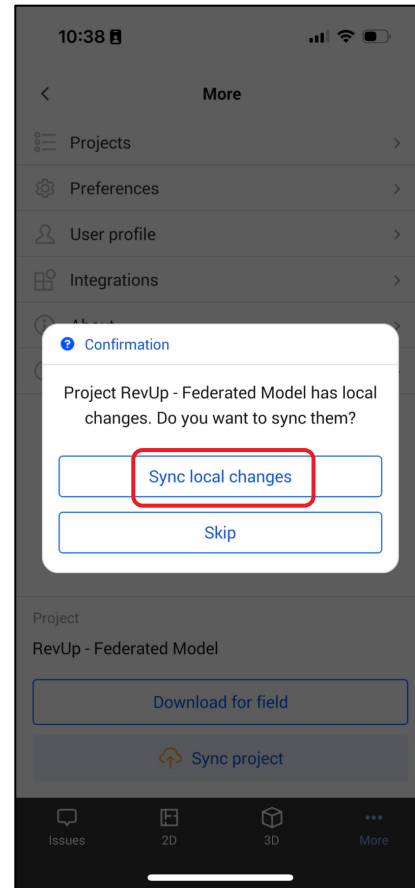

# Load Models

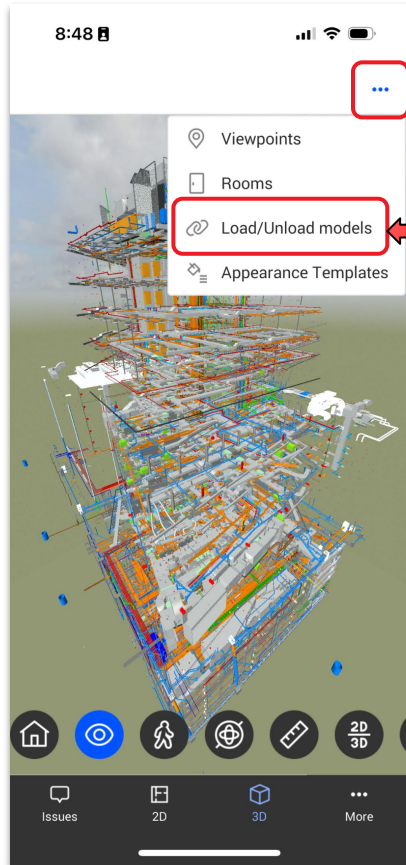

Select

Load/unload models

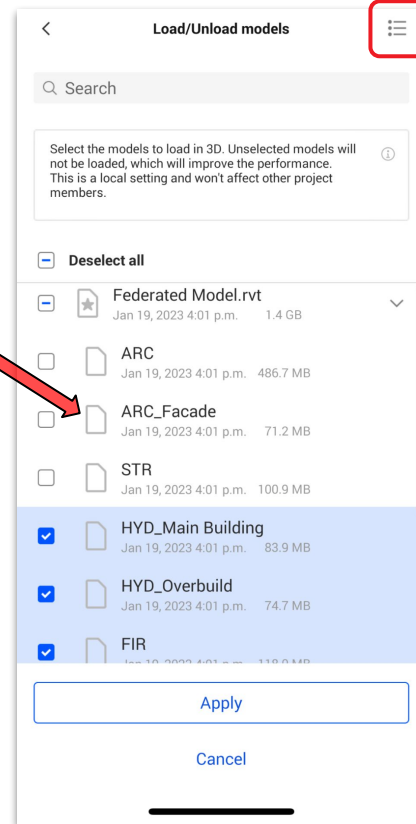

Presets in here

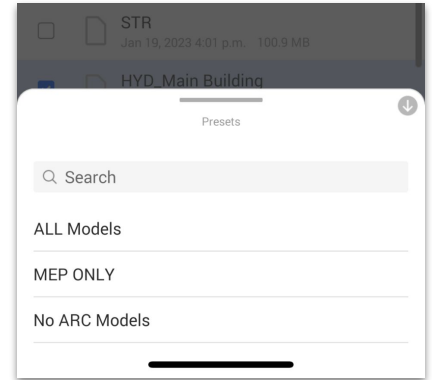



# Information of Models

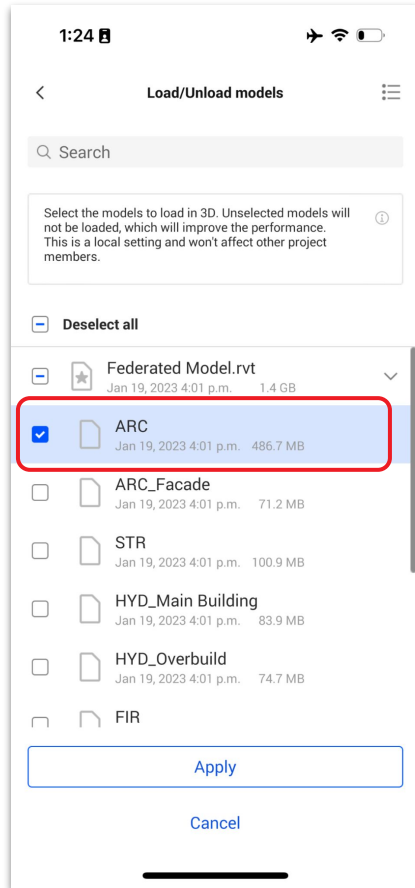

Press and hold model  
for model information

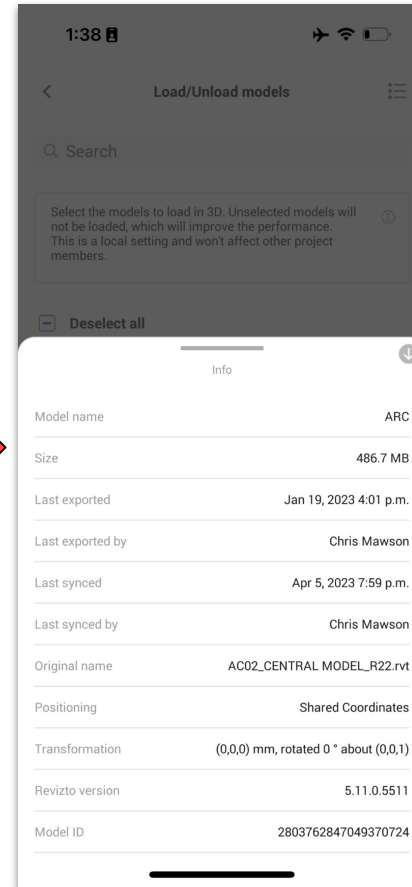

# Navigation - 3D

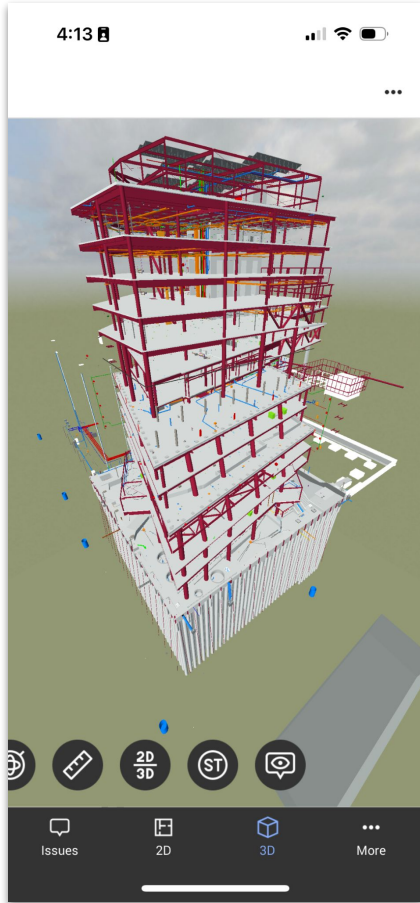

## 3D Navigation gestures:

- 1) Single finger = Look
- 2) Two fingers = Pan
- 3) Double tap and hold = Rotate
- 4) Pinch = Zoom
- 5) Hold = Joystick

Hold screen to engage navigation joystick & move with thumb. Speed increases when moved further from centre



# Navigation - 3D



Level shown here - you need model loaded which is referencing levels

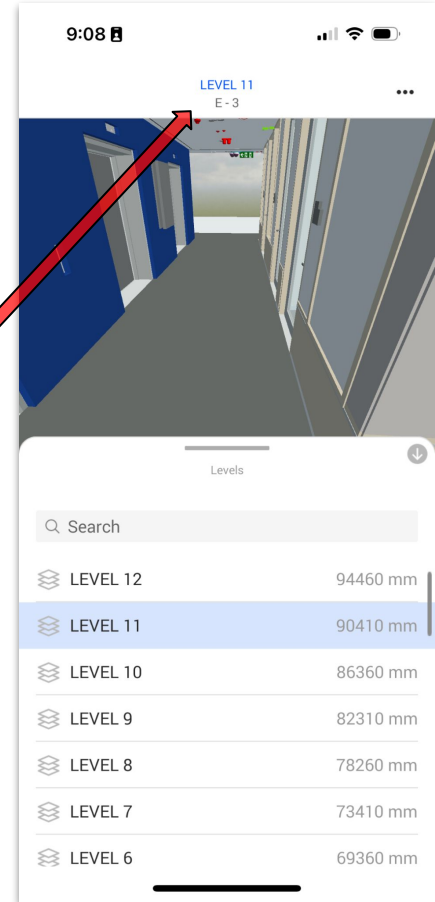

Select level to teleport to same location on another level

# Navigation - 2D

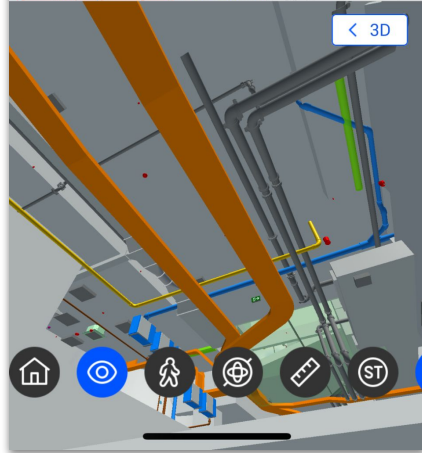
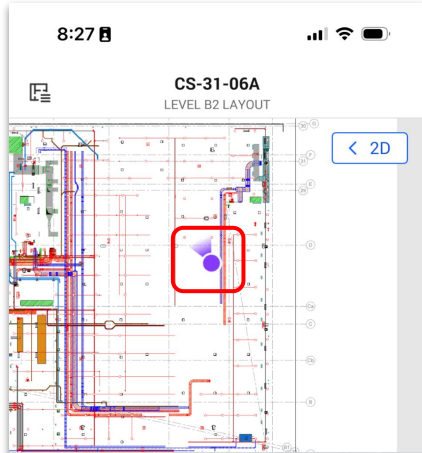

## 2D Navigation gestures:

- 1) Teleport on 2D = Click on sheet
- 2) Purple Icon = Location & direction
- 3) Pinch = Zoom
- 4) Two fingers = Pan

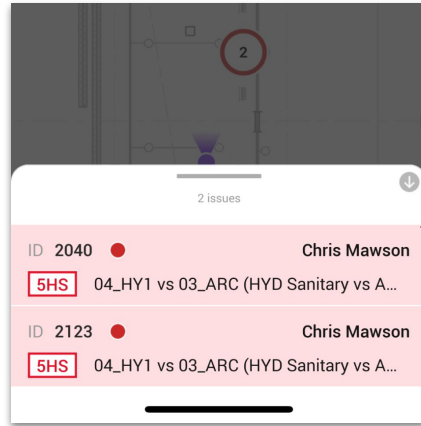

Filter issues on sheet

Select issue will open up in Issue Tracker

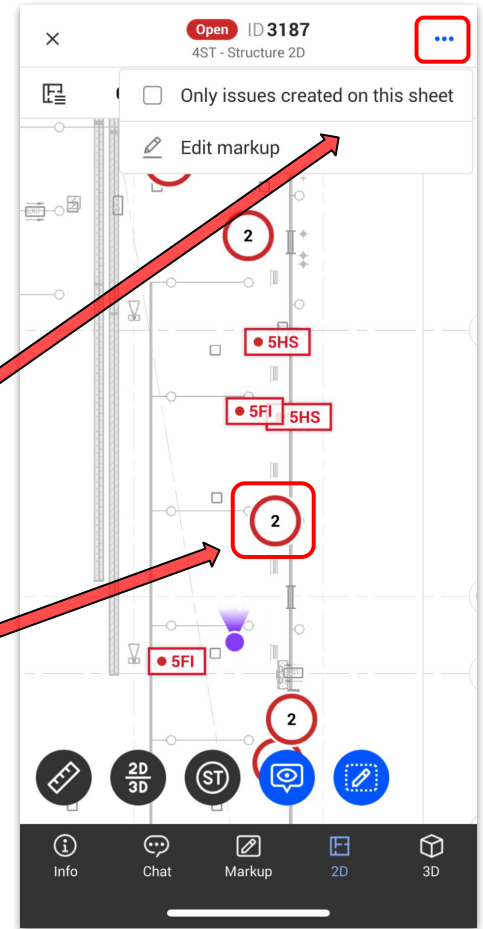

# Home screen

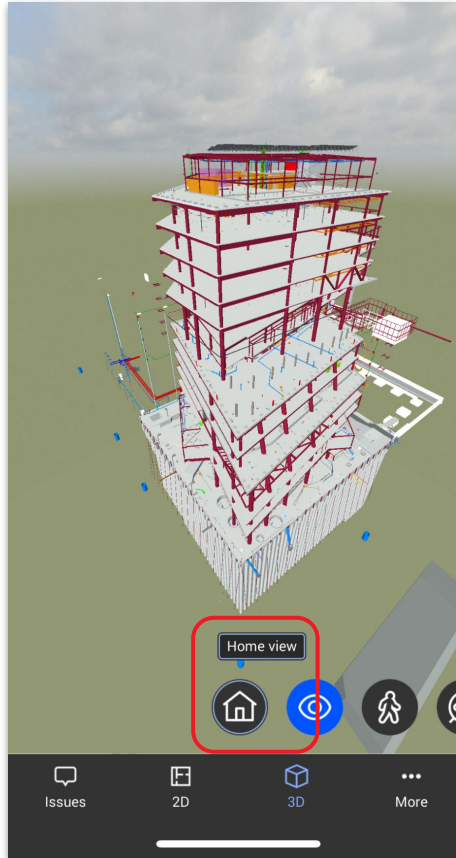

## Navigation buttons

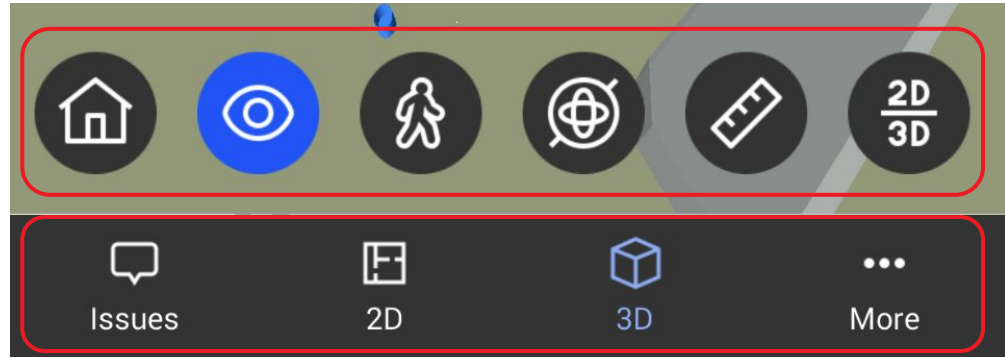

Issue tracker / 2D Sheets / 3D Model Environments

# Navigation Buttons

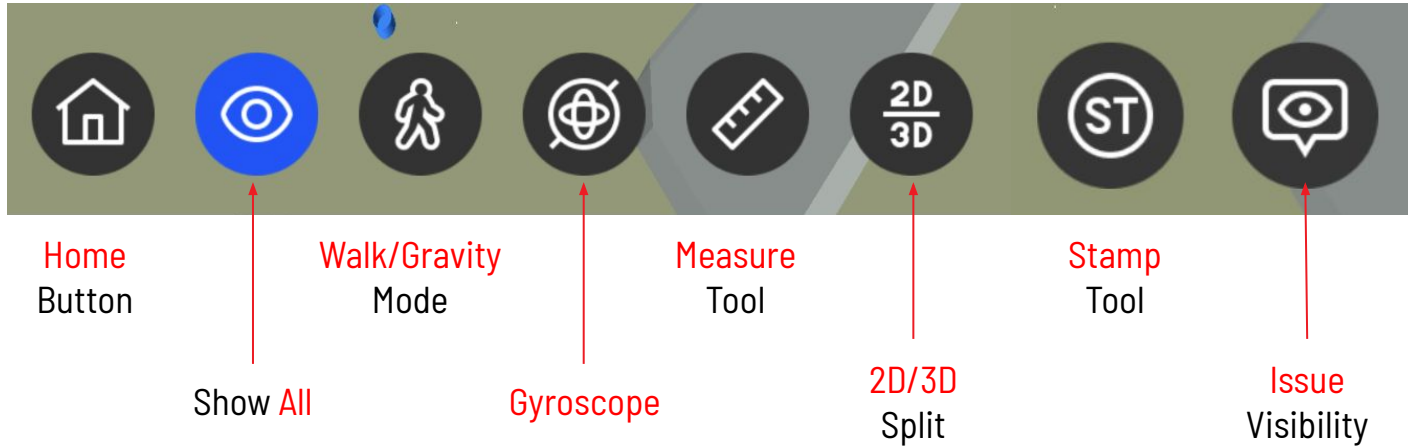

# Navigation Buttons

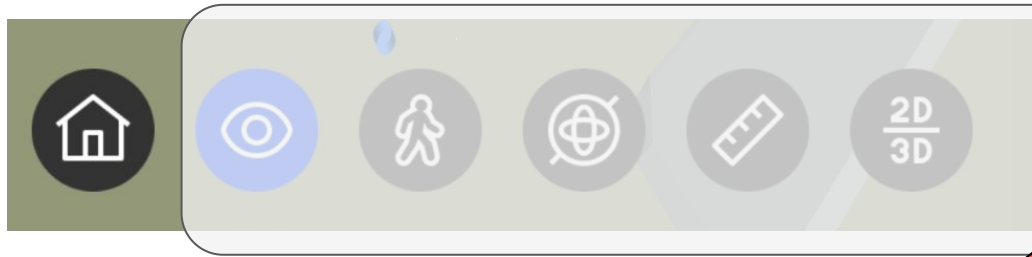

Home  
Button



Rests view & overrides  
to saved **HOME** view

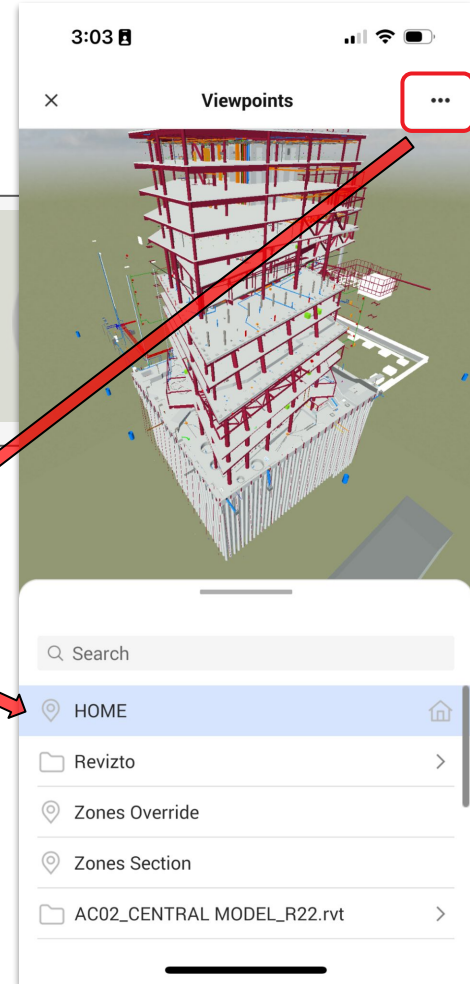
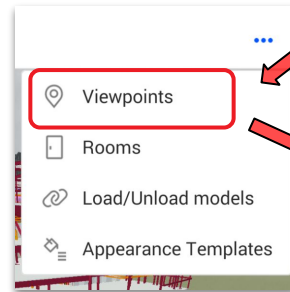

# Navigation Buttons



Show ALL



Resets ALL overrides applied to view, e.g. if you hide an element it will re-appear

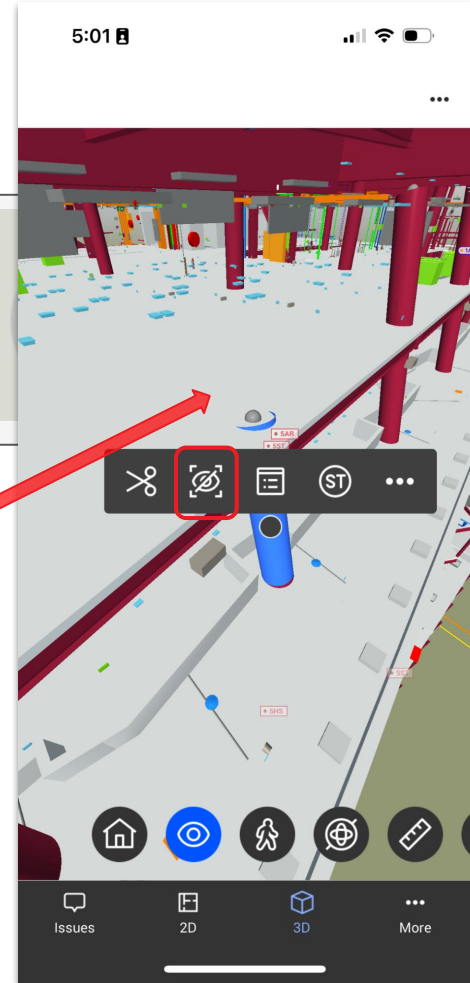



# Navigation Buttons

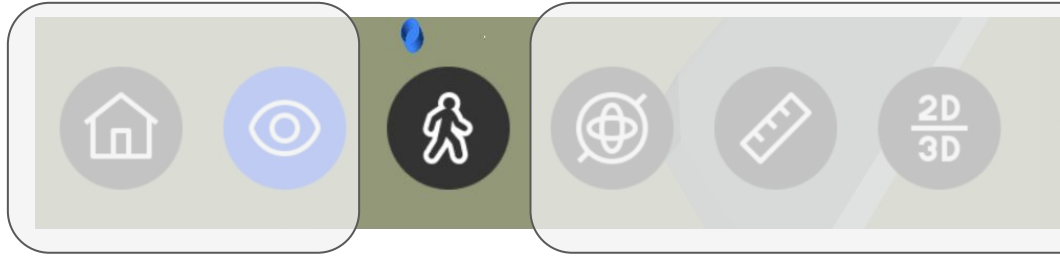

Walk/Gravity  
mode



Engages **walk & gravity** mode.  
Can't walk through walls etc.



# Navigation Buttons



Gyroscope  
mode



Engages Gyroscope model.  
Align with wall then move phone etc.

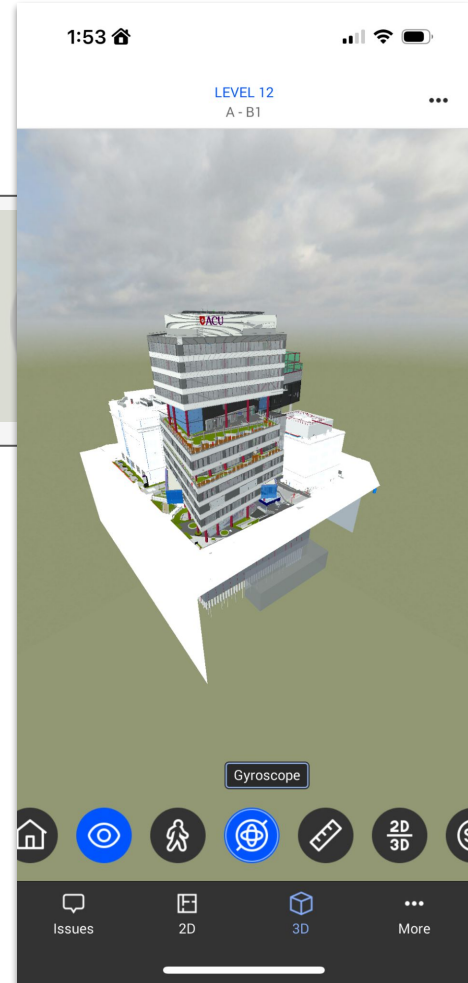

# Ruler Tool

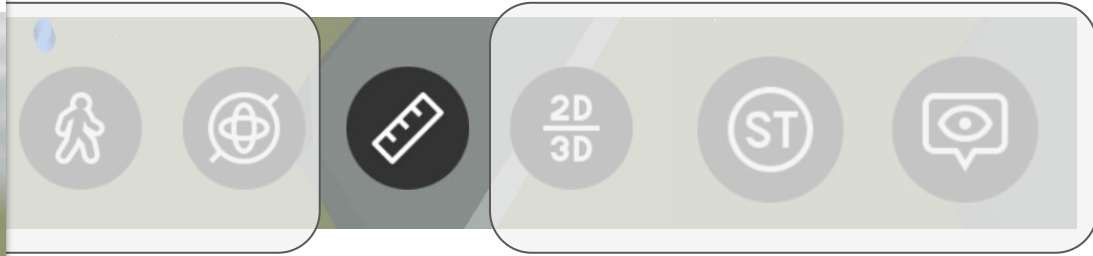

Ruler  
Tool



Opens up measure tool dialogue

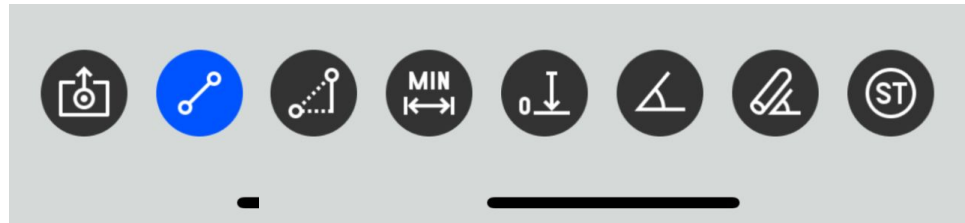

# Ruler Tool

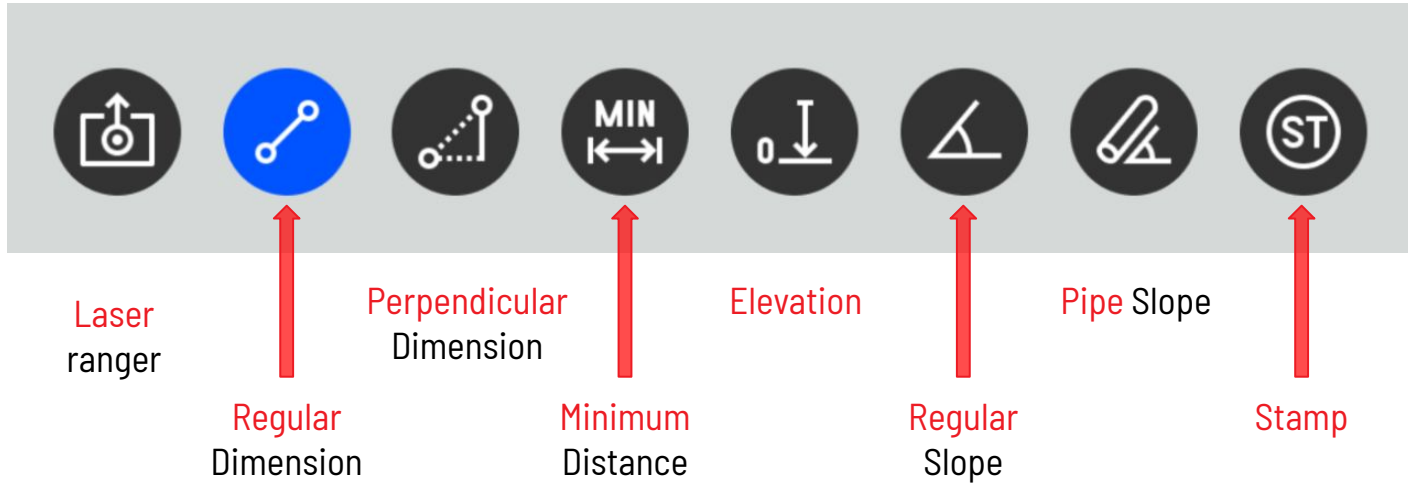

# Ruler Tool



Laser  
ranger



Distance between two  
perpendicular points



# Ruler Tool



Regular  
Dimension



Point to point dimension



# Ruler Tool

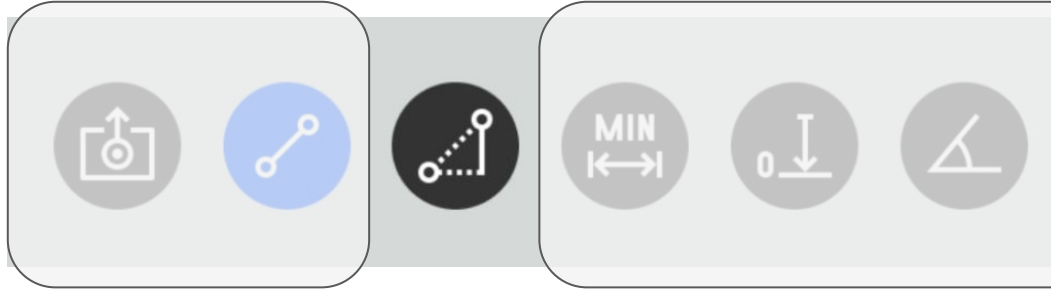

Perpendicular  
Dimension



Perpendicular dimension  
between two points



# Ruler Tool

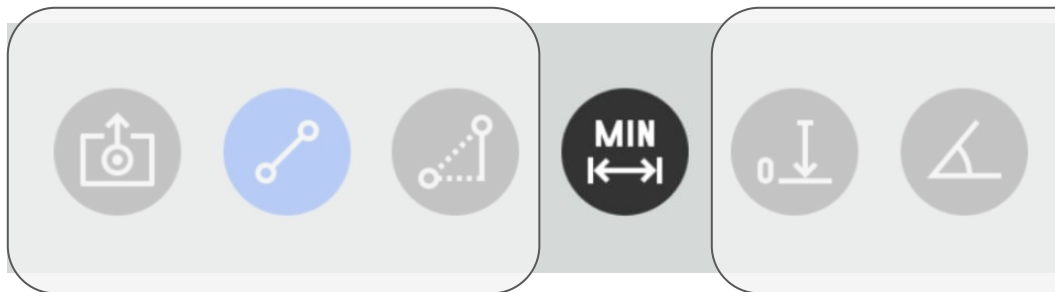

Minimum  
Distance



Minimum distance  
between two elements

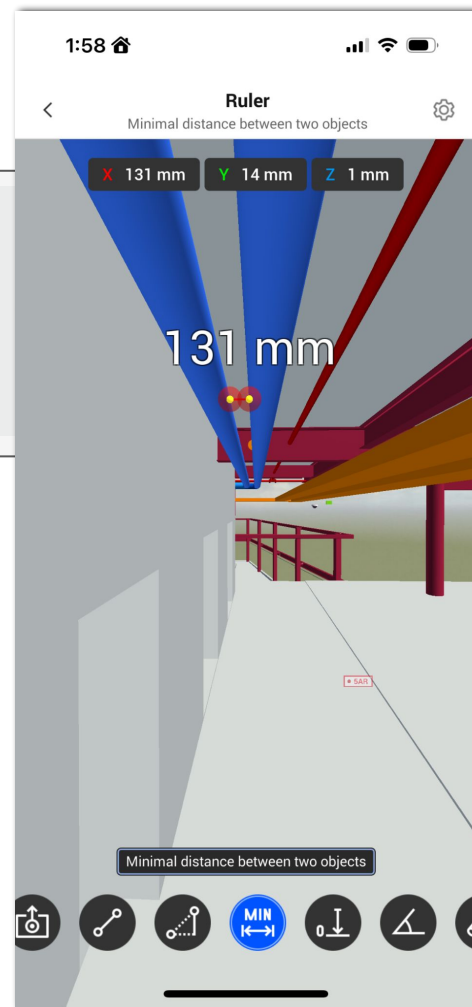



# Ruler Tool



Elevation

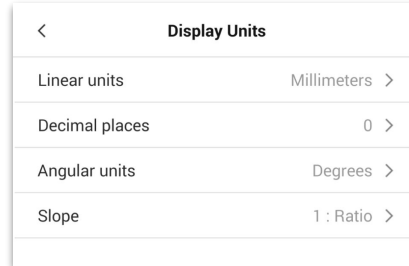

Coordinates

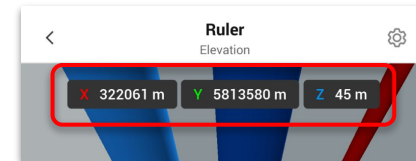

# Ruler Tool

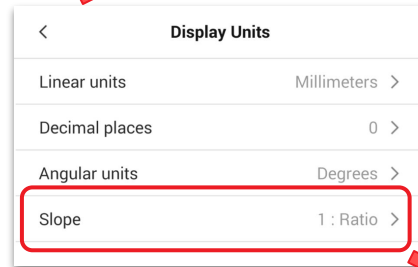

Regular Slope

Slope of any element  
(NOT a pipe)



# Ruler Tool

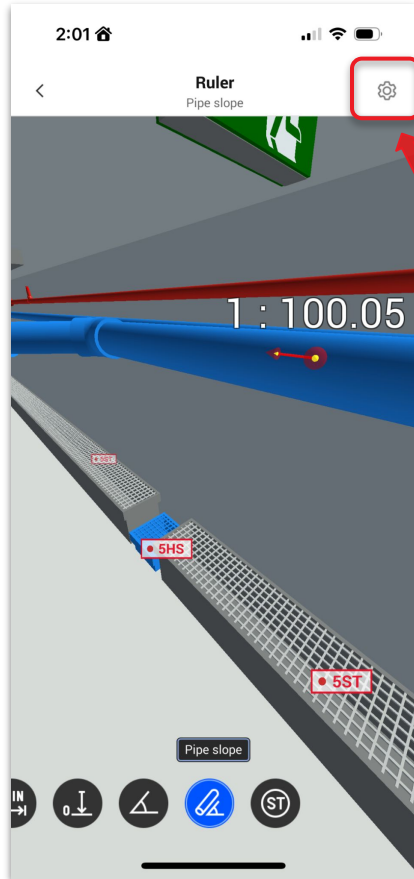

Pipe Slope

Slope of any pipe

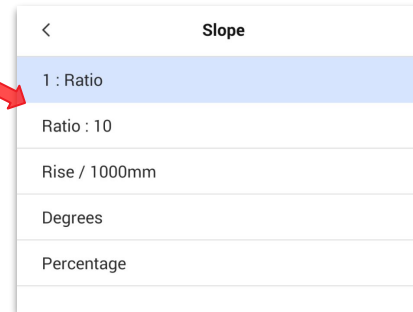
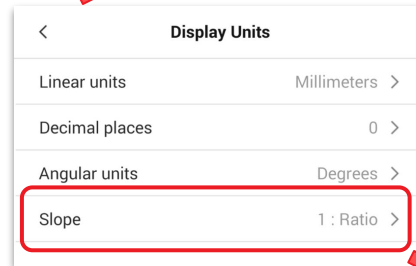

# 2D/3D Split

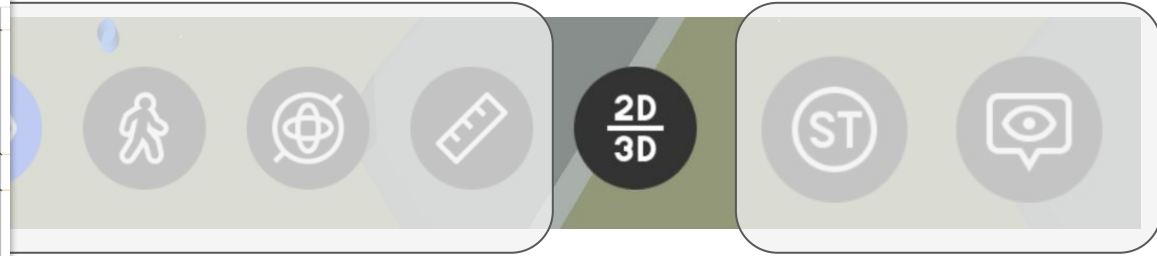
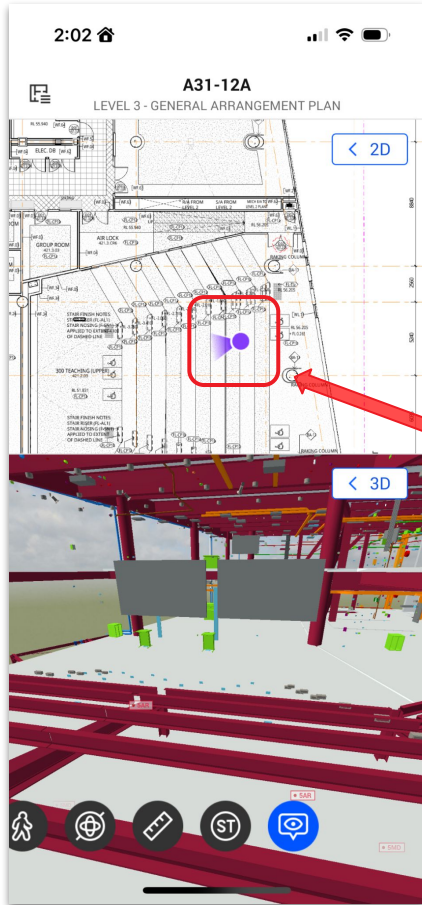

2D/3D  
split



Splits screen to show 2D  
PDF & 3D model - purple  
dot shows location /  
direction in 3D model

# 2D/3D Split

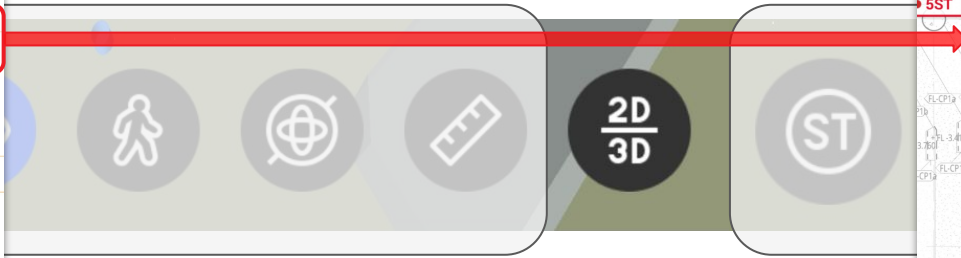
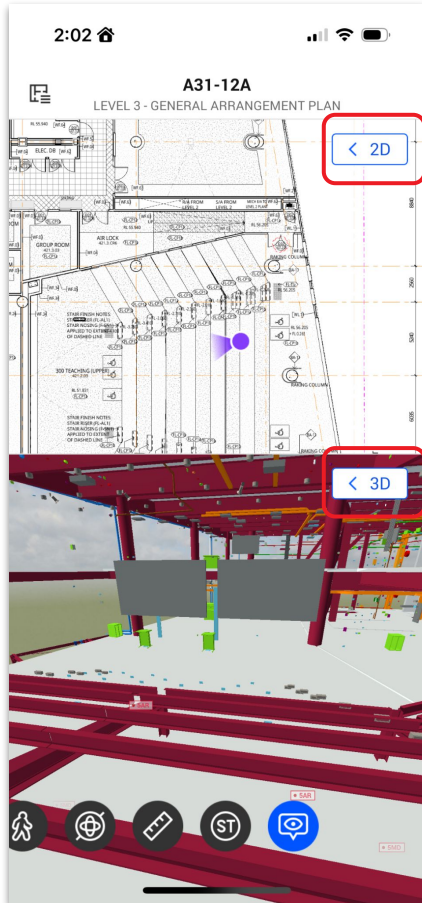

2D/3D  
split

Select 2D or 3D button  
to toggle between  
drawing/model

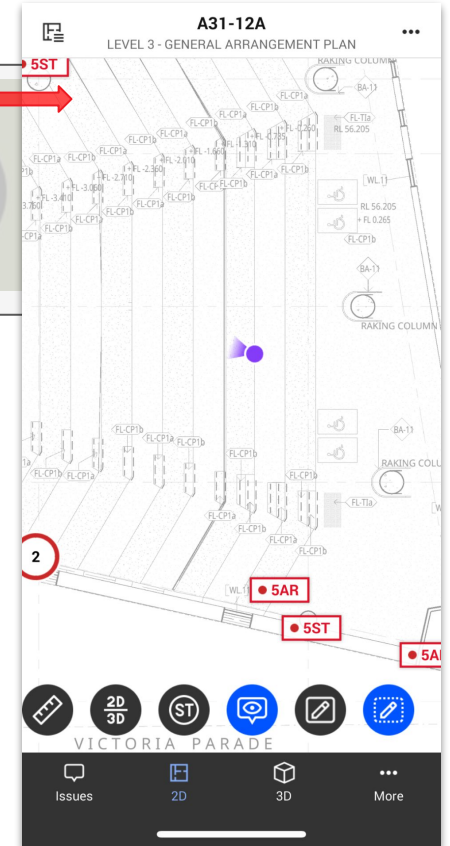

# Stamps

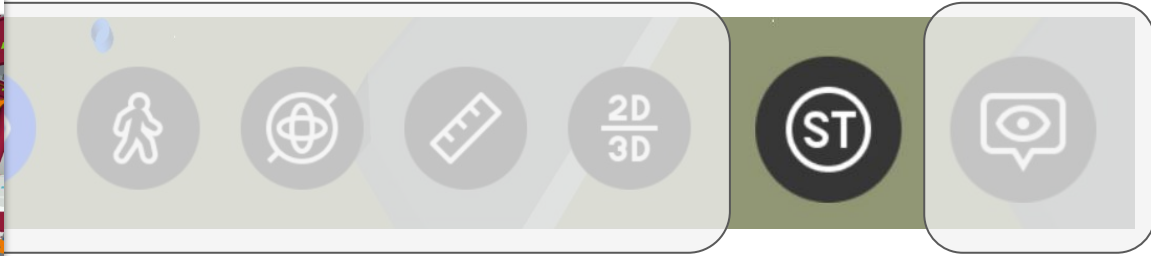
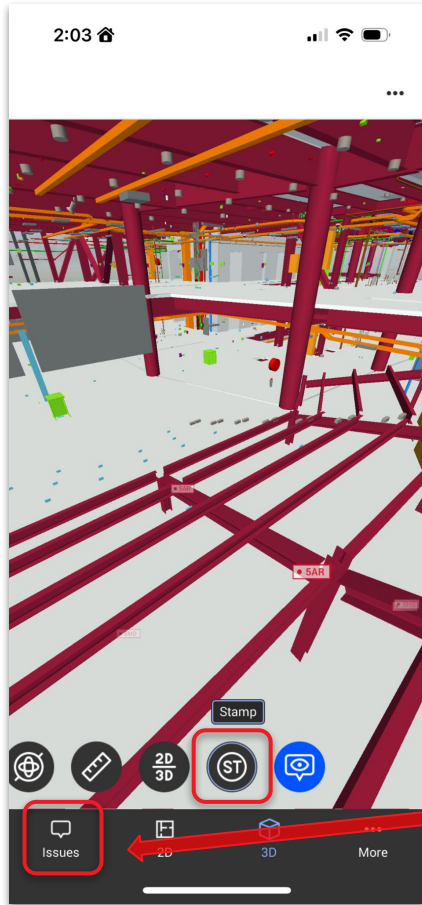

Stamps



Create a Stamp and  
send to Issue Tracker

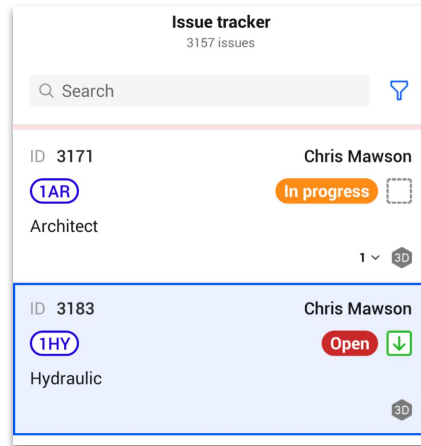

# Stamps - create an issue

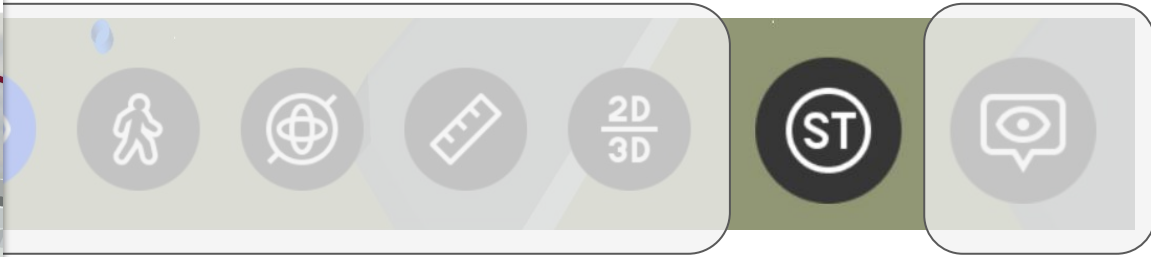
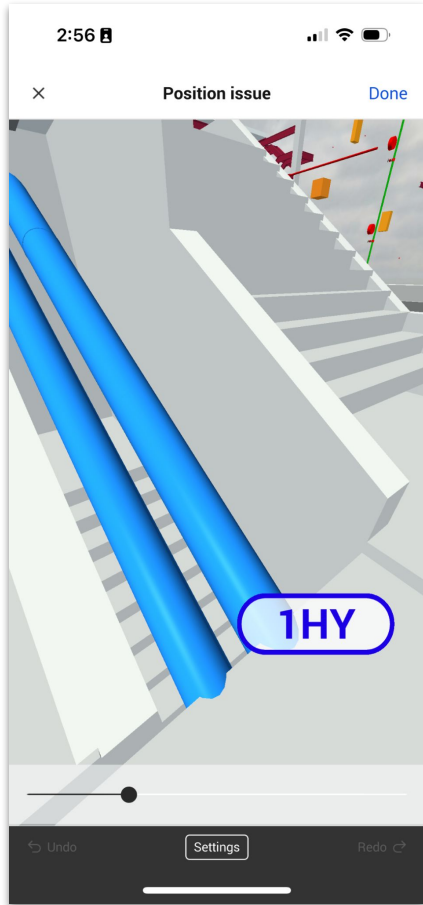

Stamps

## 2D Markup tools

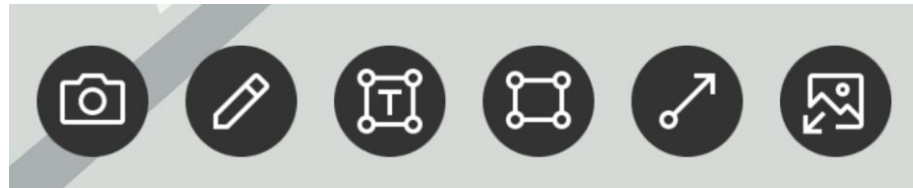

Photo

Pen  
(Sketch)

Text

Box  
(Clouds)

Arrow

Image

# Stamps - create an issue

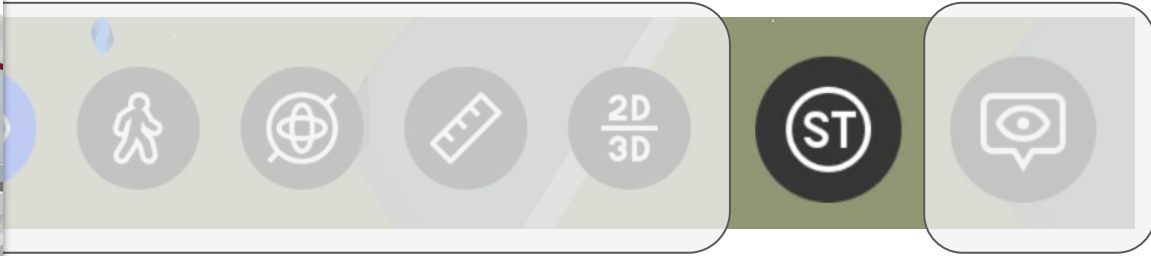
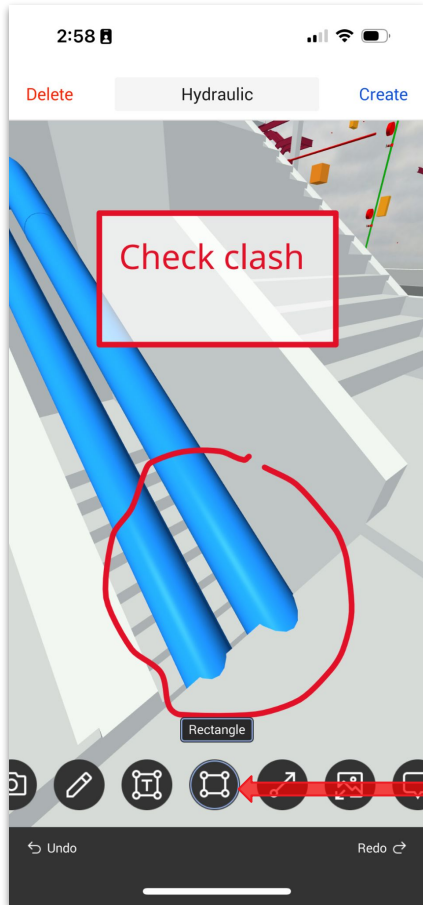

Stamps

Rectangle & cloud line

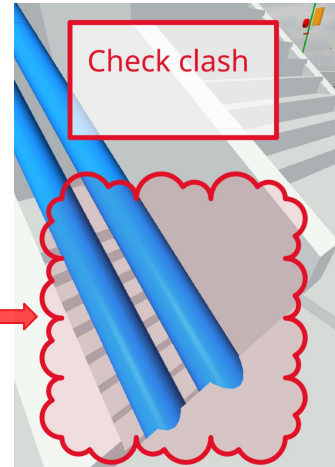
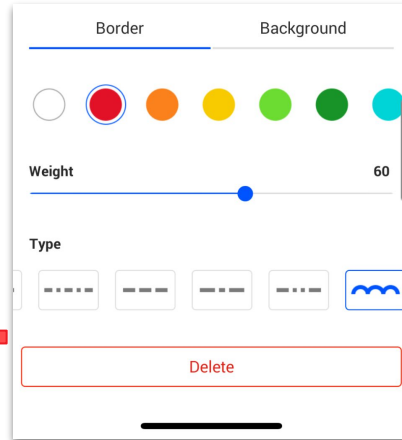



# Issue Visibility

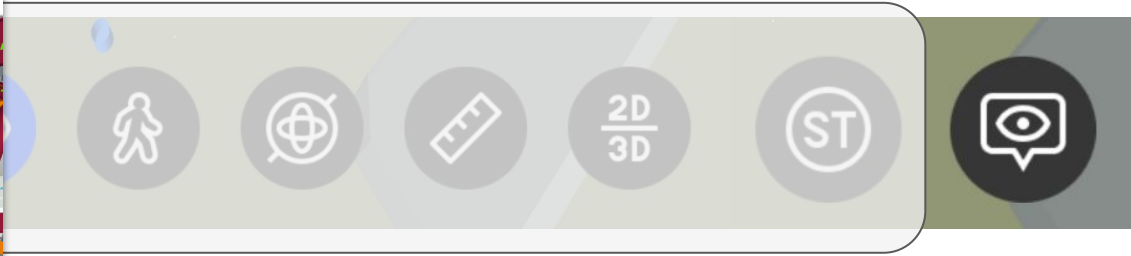
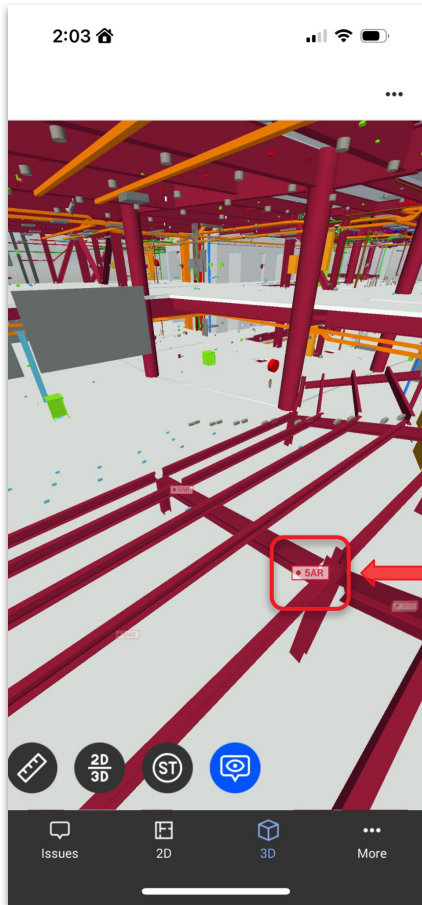

Issue  
Visibility



Turns pins On/Off  
in 3D model



# Issue Tracker

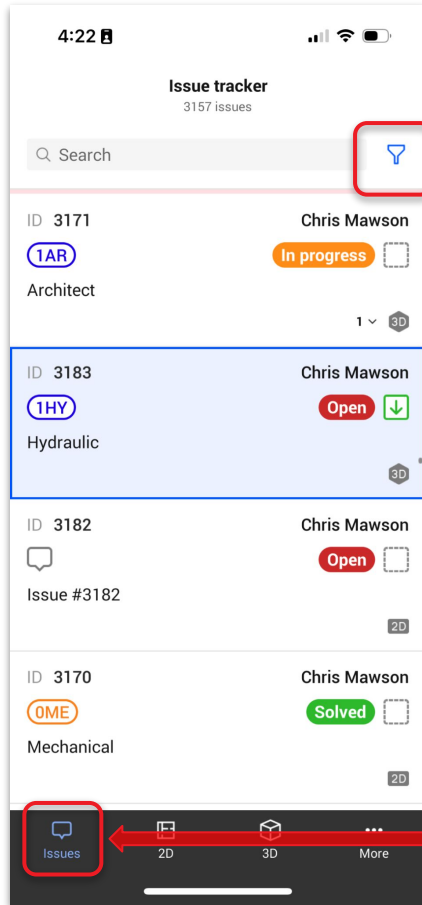

Open filter to select relevant issues

Select **Issues** to open Issue Tracker

## Issue Tracker

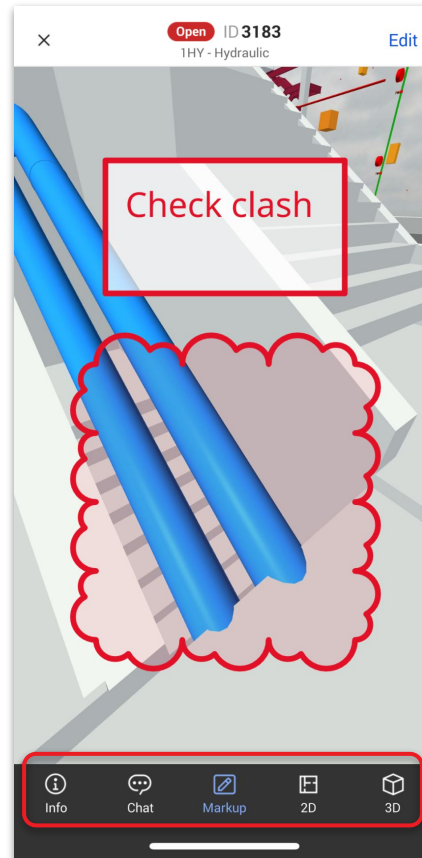

Check clash

## Issue Information

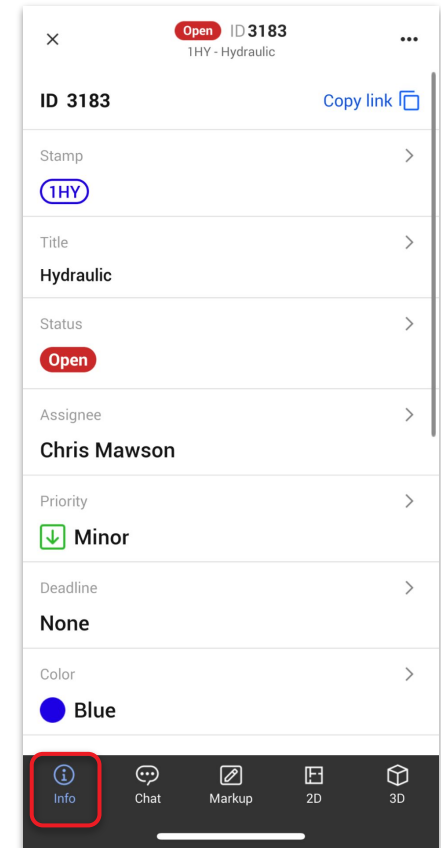

# Issue Tracker

## Chat Box

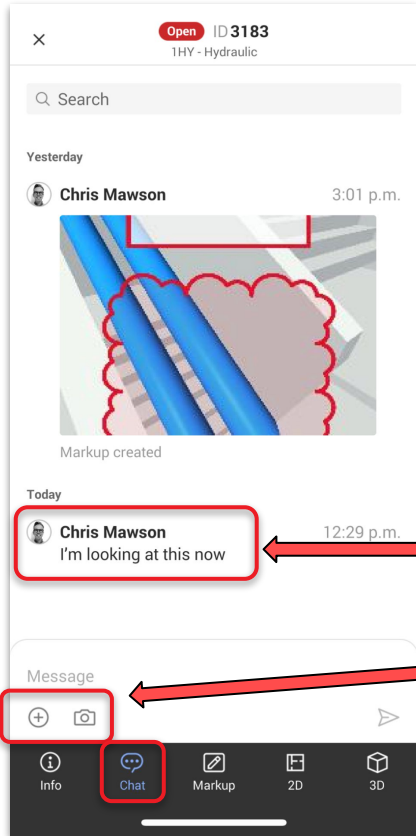

Add conversation

Add files/photo

## Chat - add docs/photo

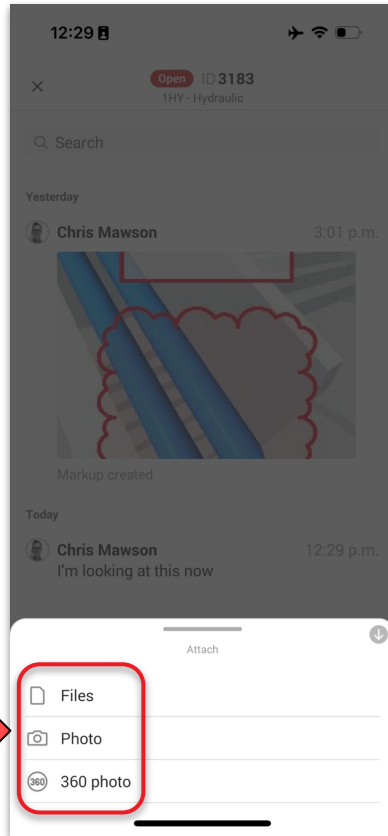

## Chat - Docs

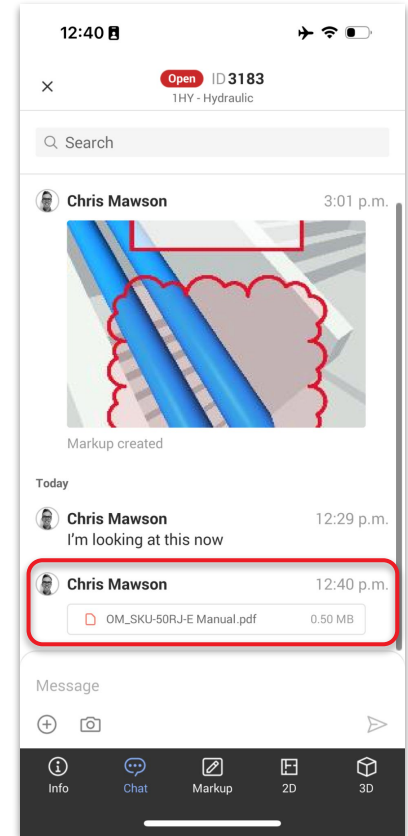

# Issue Tracker

Issue **Hyperlink**

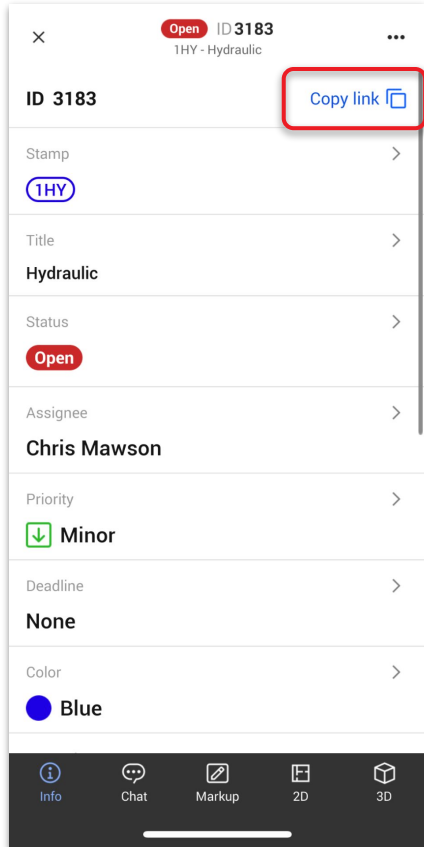

Paste **hyperlink** in another chat

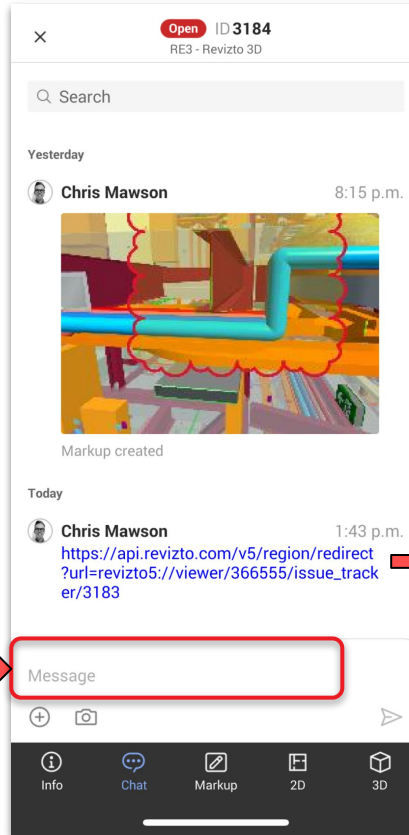

Double tap in chat to paste **hyperlink**

Other **issue**

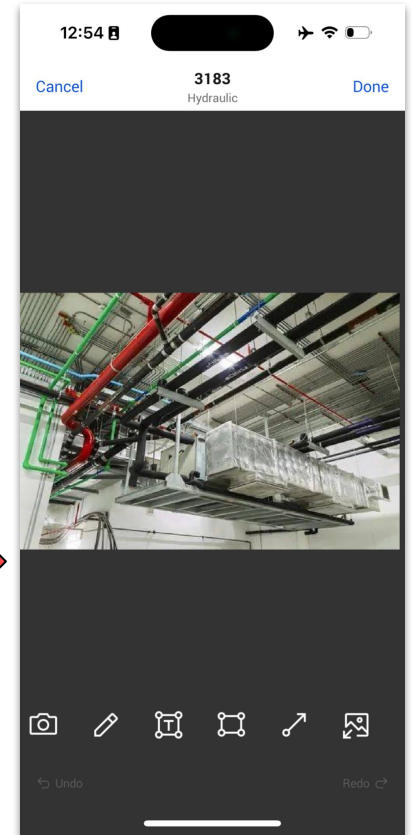

Links to other issue

# Issue Tracker

2D Markup

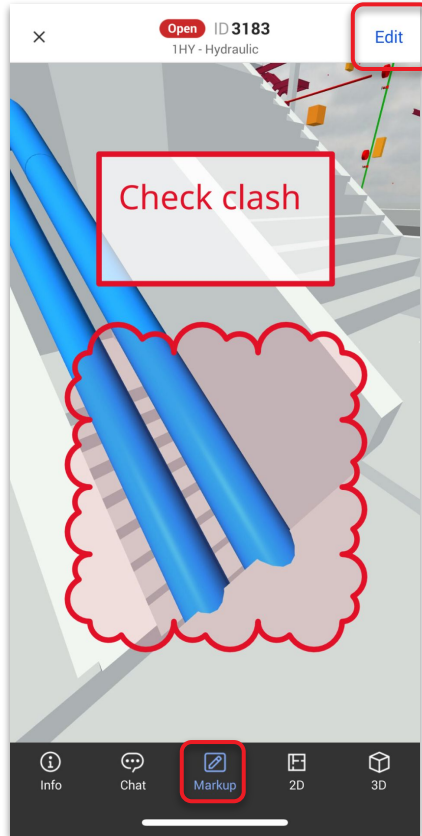

Edit markup

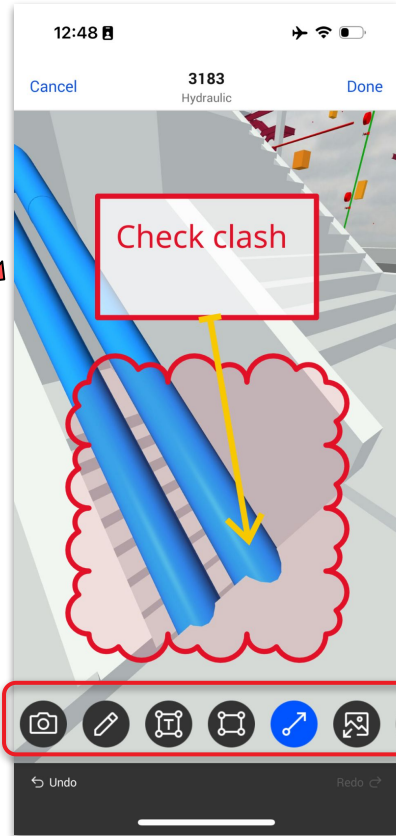

Take a photo

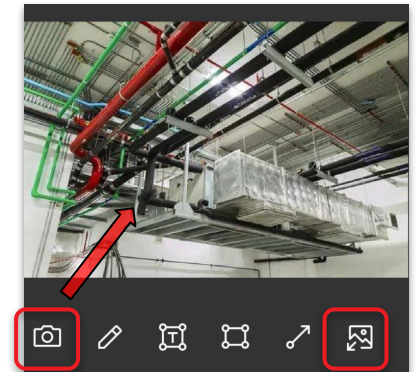

Add saved photos

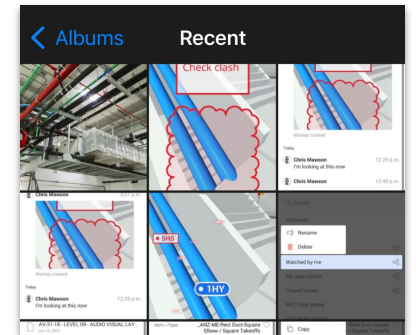

# Issue Tracker

2D Sheet view

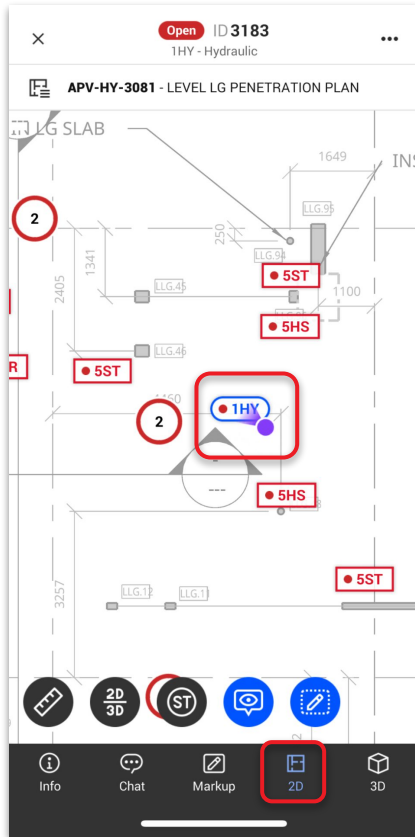

3D view

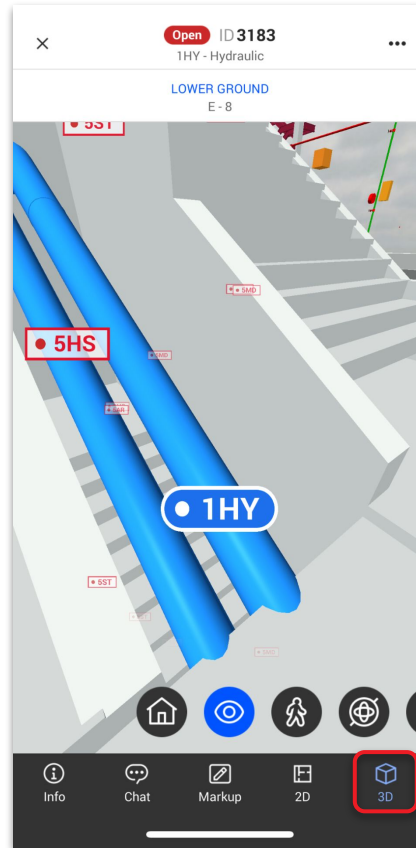

Select filters in IT

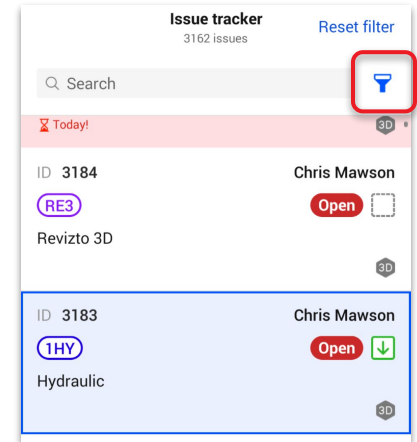

Hold on filter to delete/rename

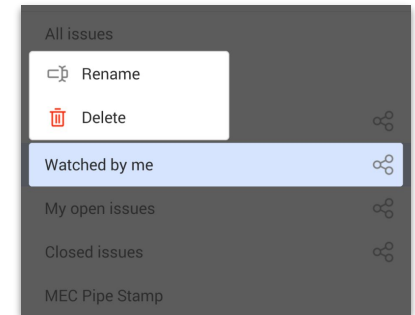

# Section Cut

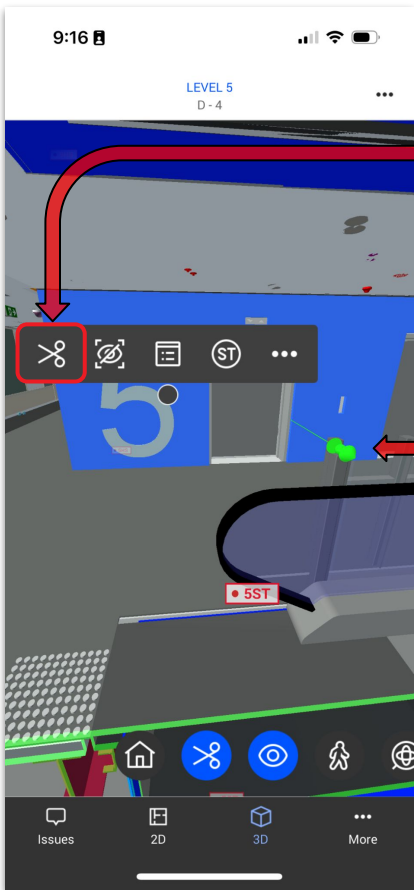

Select an element and use **Section Cut**

Drag tool to **push/pull** section

Toggle section **on/off**

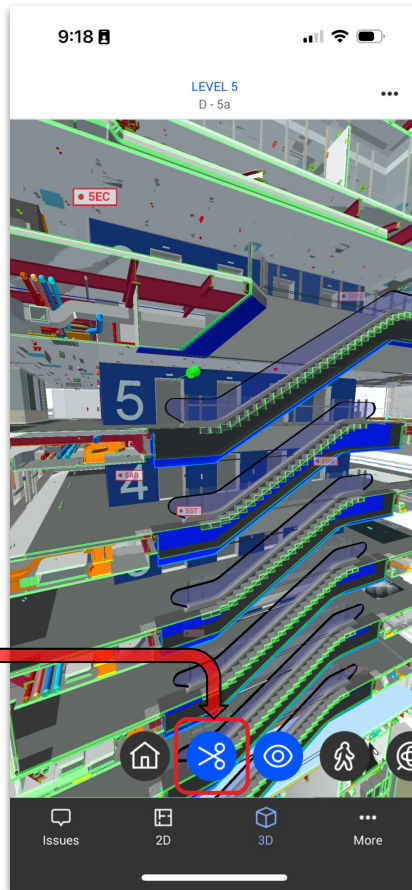

Save view by creating Stamp

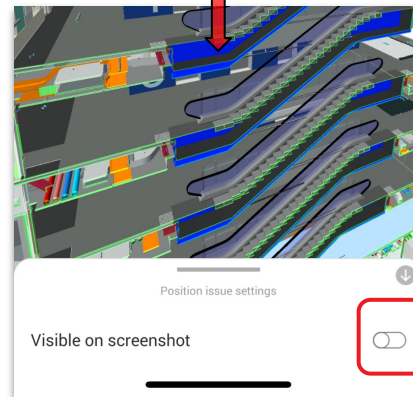
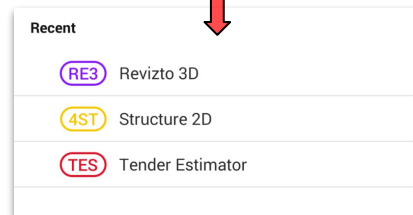

# Appearance Templates

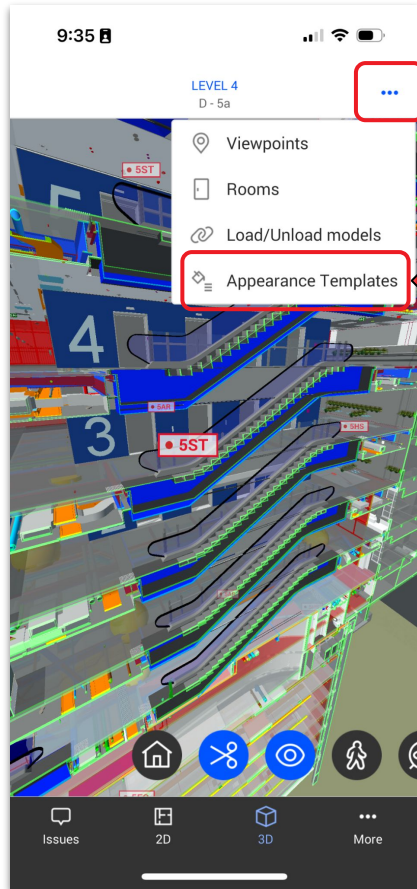

Select Appearance Template

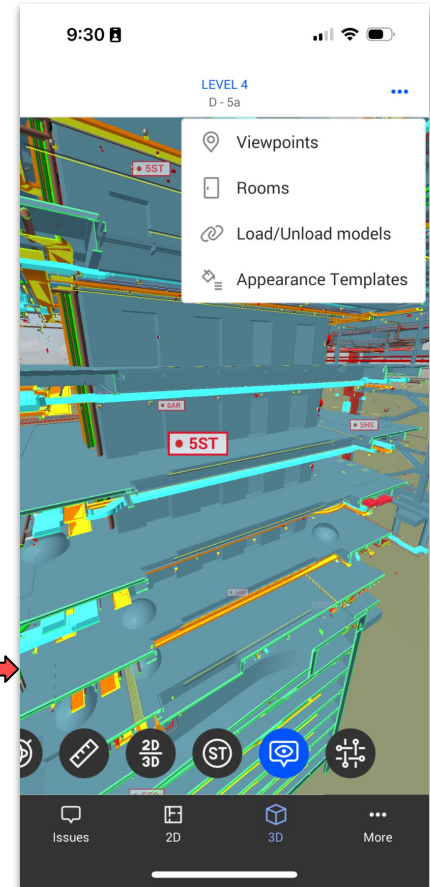
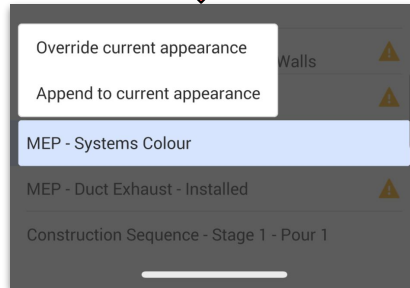



# Rooms

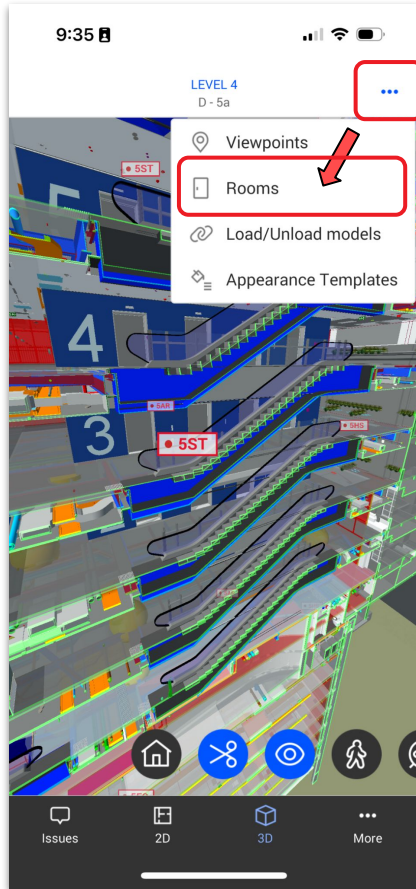

Select **Rooms**

Search for room

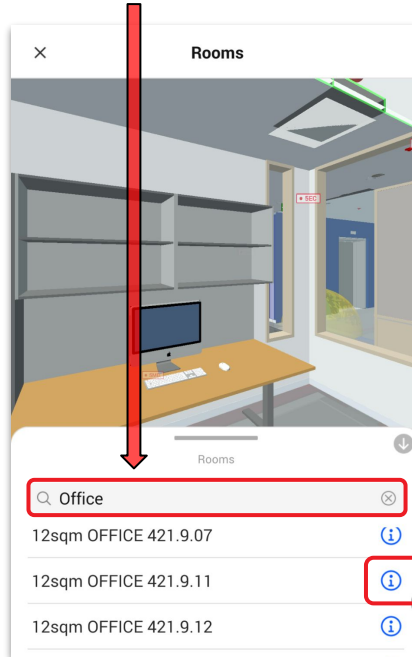

**Properties** of room by selection **i** button

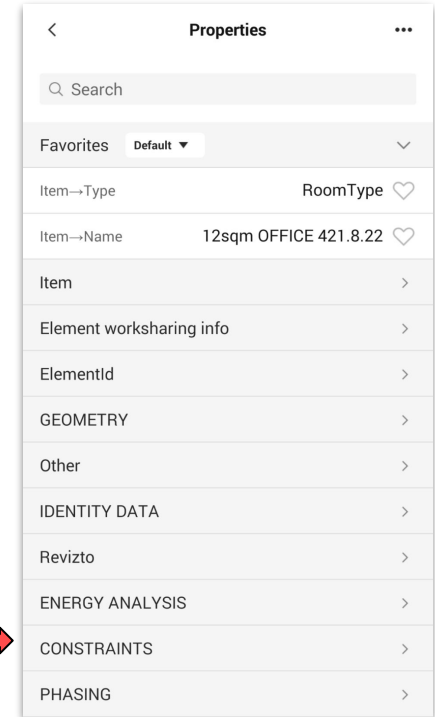

# Viewpoints



Select Viewpoints

Select predefined view

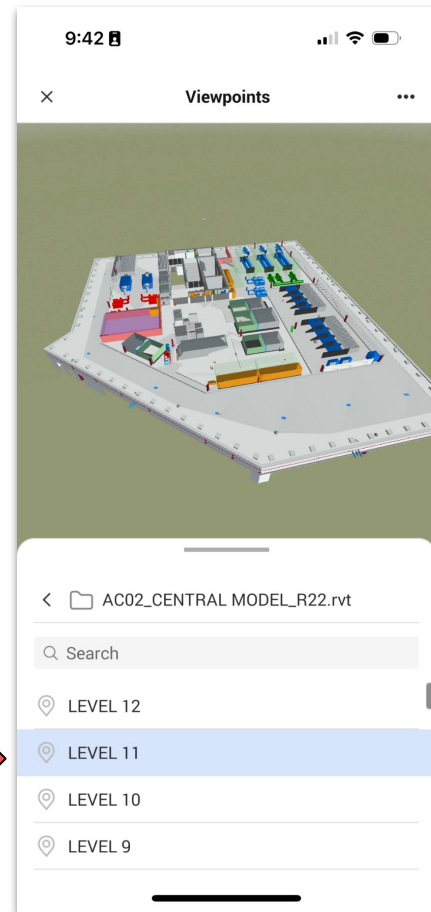
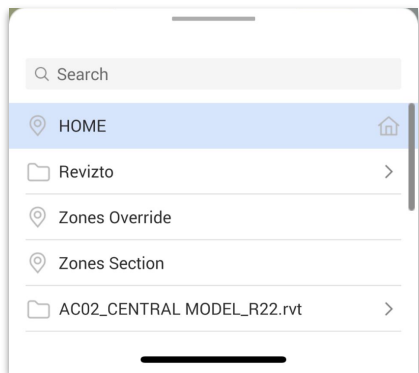

# Properties

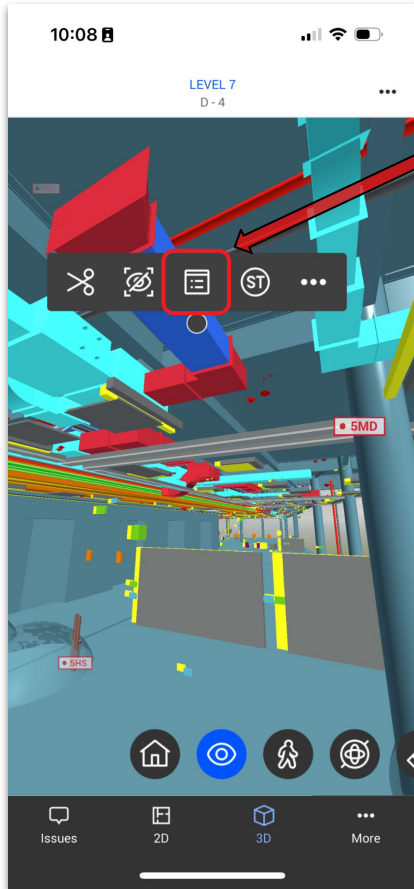

Select **element** - pop up box will appear - select **Properties**

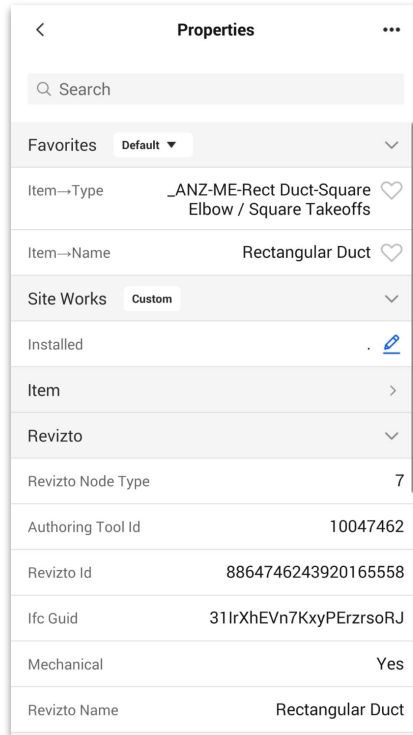

Add **Custom** Properties

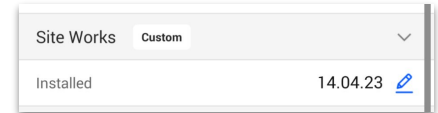
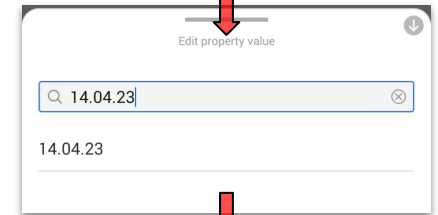
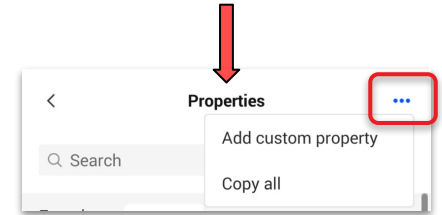

# Properties - select all & overrides

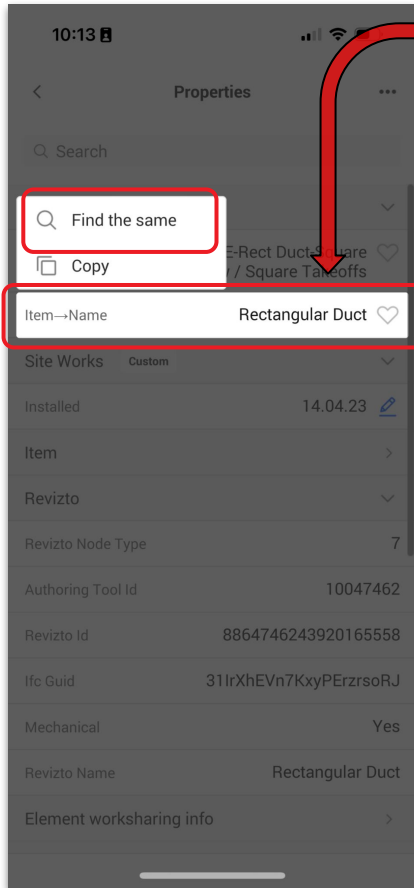

Click and **hold** property to find same

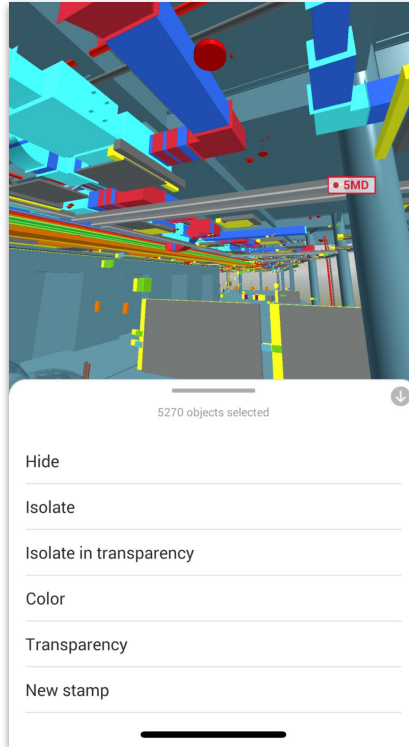

Visibility  
tools

Isolate in transparency

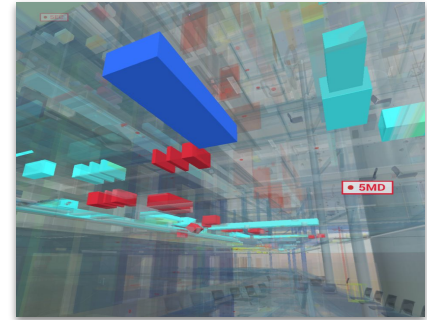

Isolate

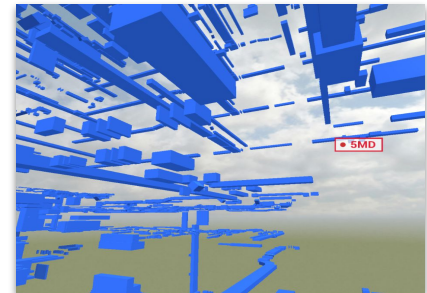

View  
overrides

# Properties - object **selection** tools

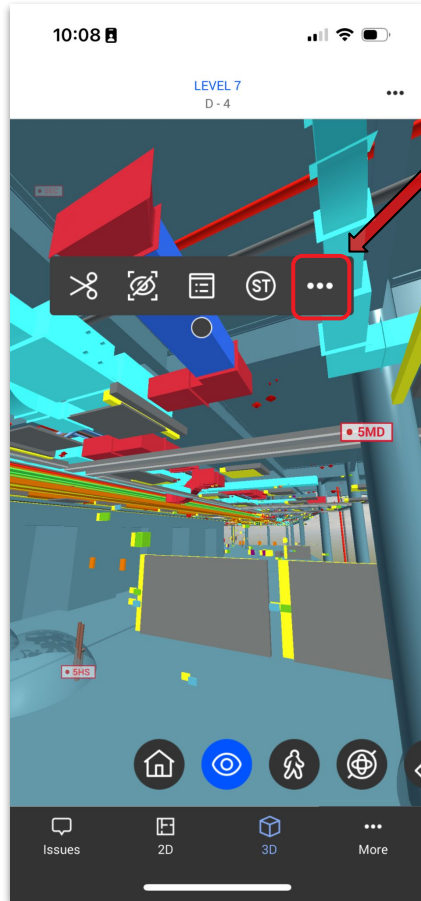

Select 3 dots to **override** visibility of element



Visibility  
tools

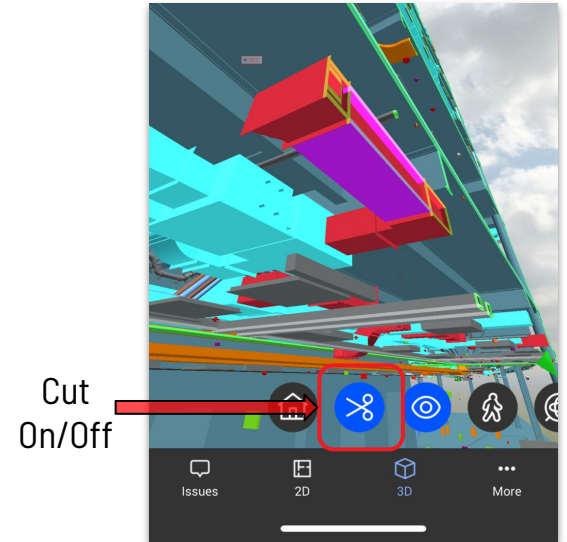

Cut  
On/Off

# 2D Drawings - Open sheets

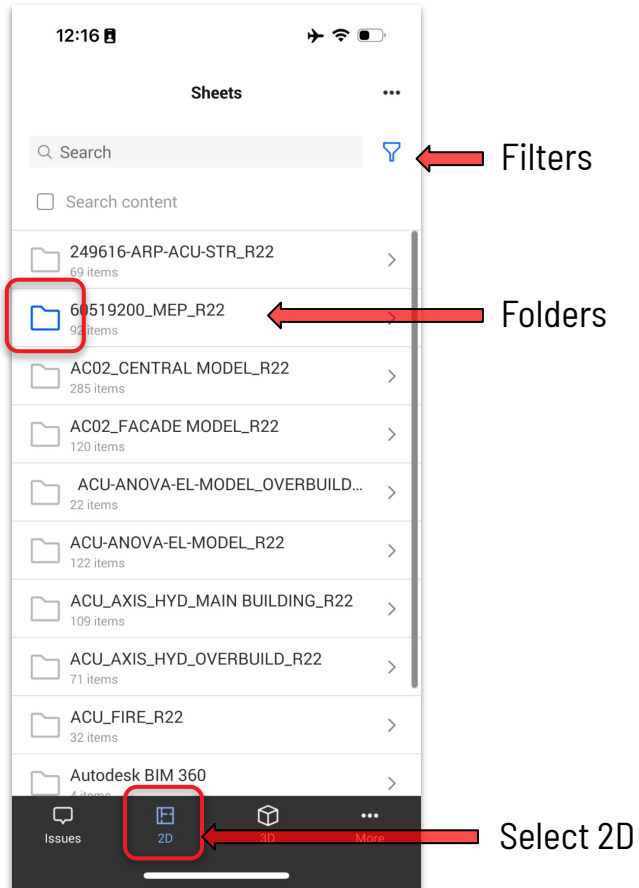

Press and hold on sheet  
to open properties

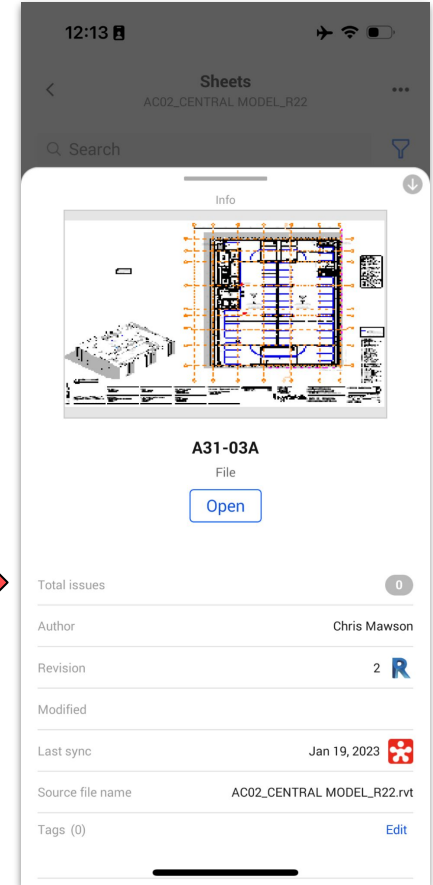
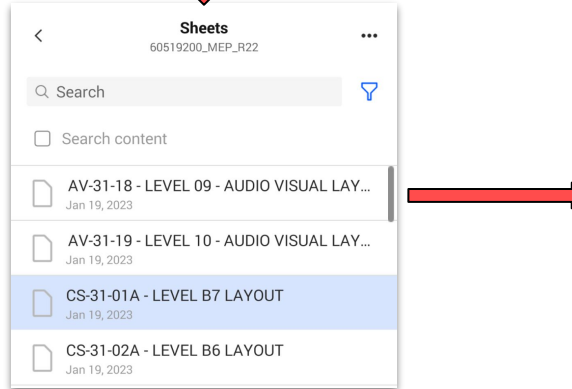

# 2D Drawings - Toolbar

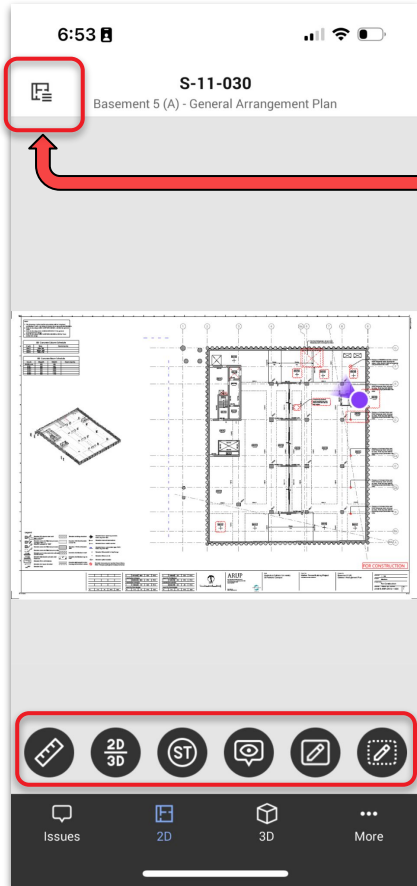

Select sheet

## 2D Tools

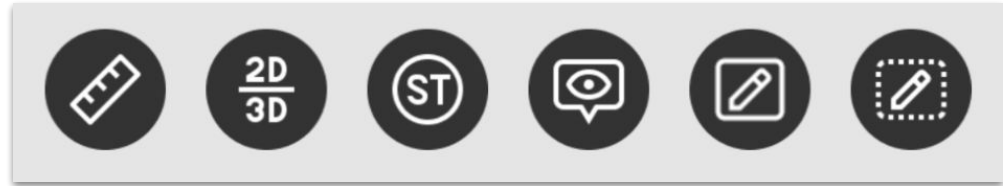

Measure

2D/3D  
Split

Stamp

Pin  
Visibility

Markups

Halftone

# 2D Drawings - Measure

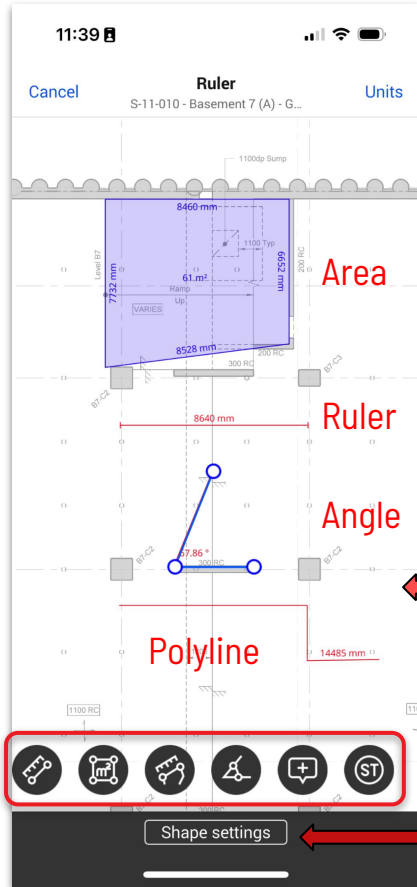

## 2D Tools



Measure



## Measure Tools



Ruler

Area

Polyline

Angle

New Issue

Stamp

Settings for each tool in here



# 2D Drawings - Save dimensions as an Issue

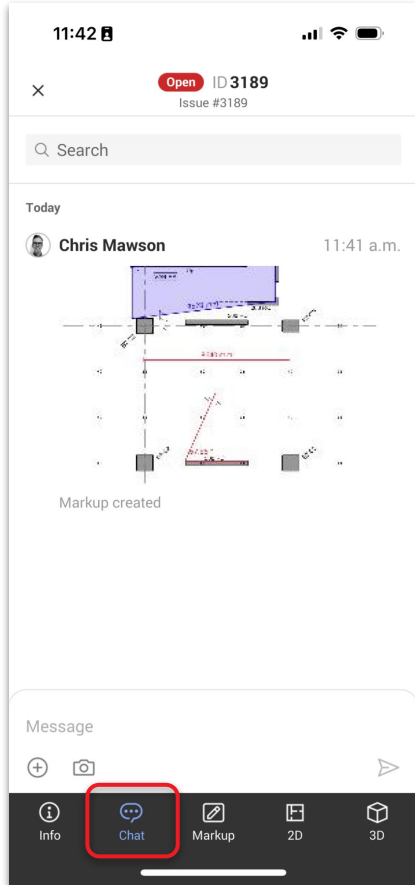

## Measure Tools



Creating an **issue** will save the dimensions to the Issue Tracker. You can view the dimensions by selecting Chat/Markup

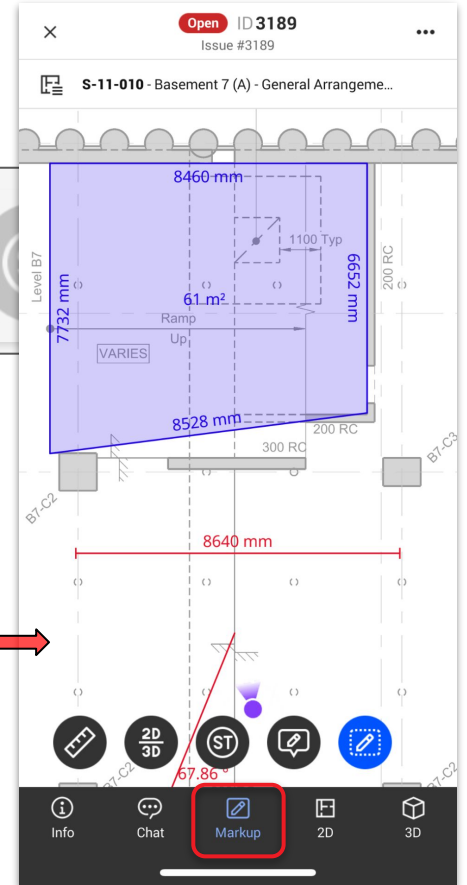

# 2D Drawings - 2D/3D Split

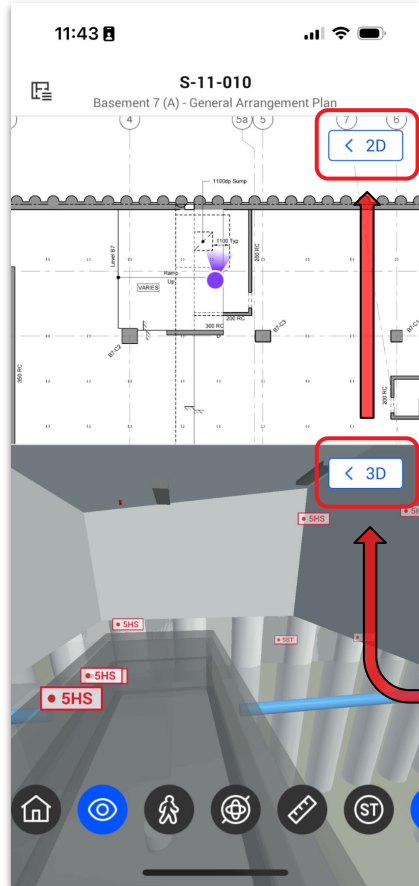

## 2D Tools



2D/3D  
Split

Split screen to show 2D PDF &  
3D model - purple dot shows  
location / direction in 3D  
model

Select 2D or 3D button  
to toggle between  
drawing/model

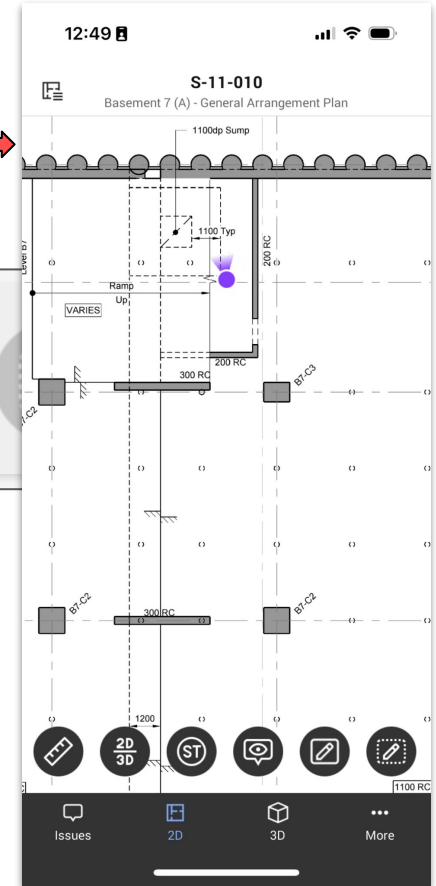

# 2D Drawings - Stamps

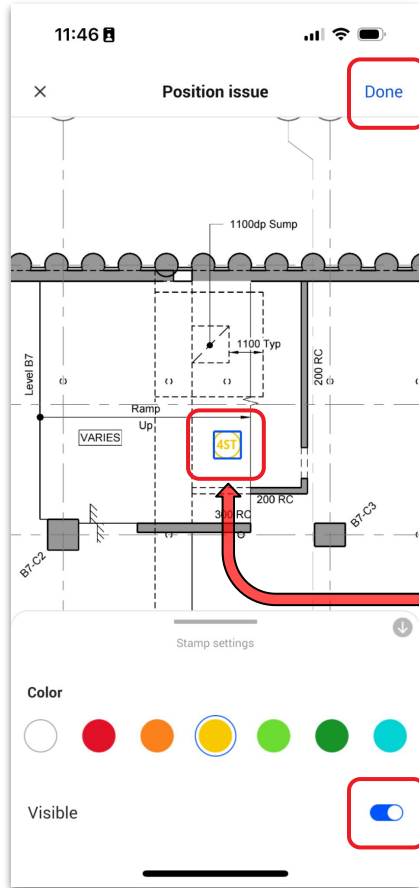

Select done to enter Markup mode

## 2D Tools



Stamp

Chose stamp & place on sheet - select settings to turn stamp visibility on/off

Markup tools & take or add a photo

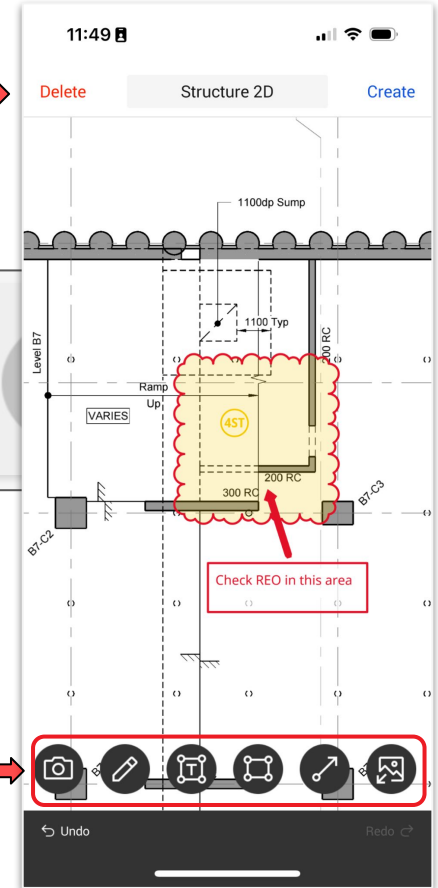

# 2D Drawings - Stamps / Pin Visibility

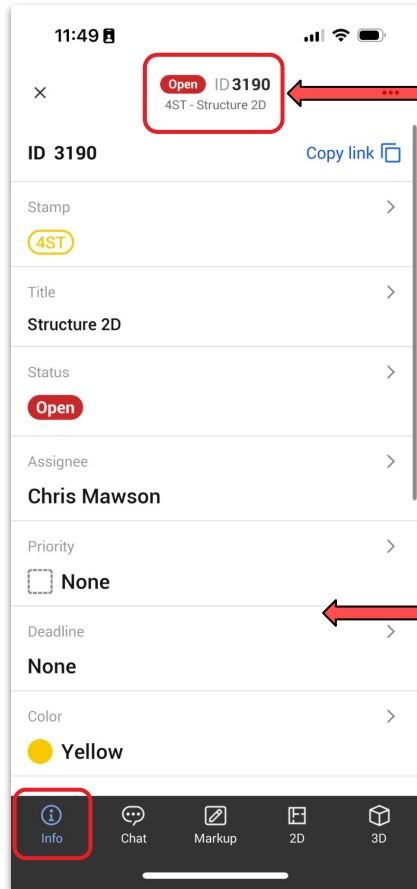

New Stamp gets pushed to Issue Tracker

## 2D Tools



Stamp

Pin  
Visibility

Metadata pulled from Stamp Template

Turn On/Off Pins

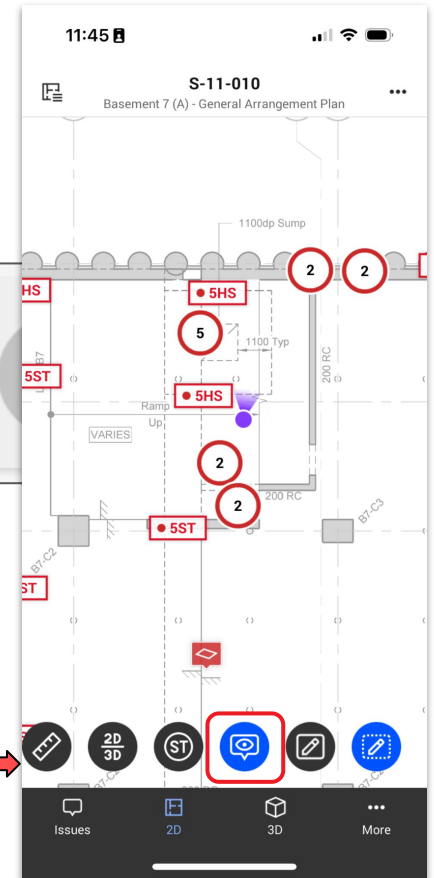

# 2D Drawings - Selecting a Pin

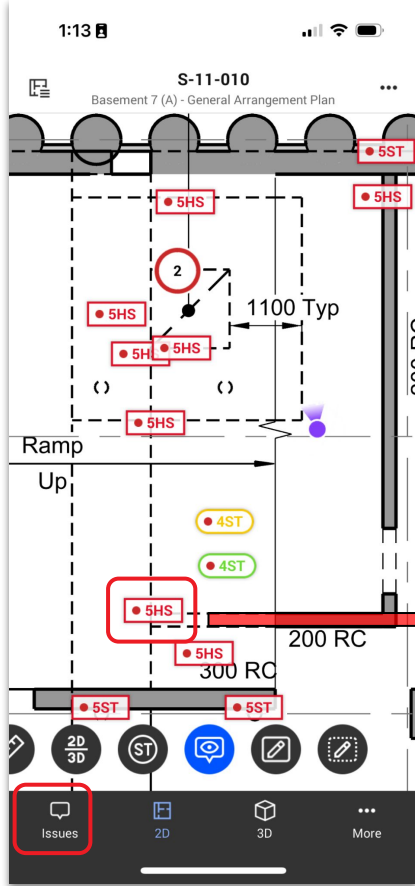

## 2D Tools



Pin  
Visibility

Selecting a Pin will take you to the Issue Tracker

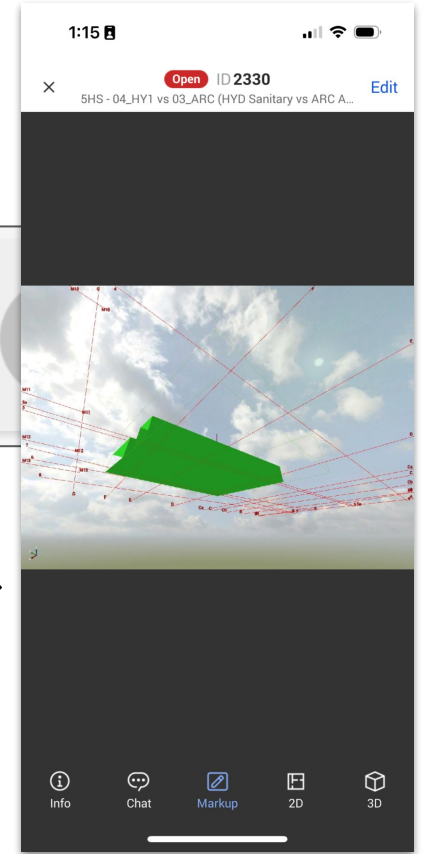

# 2D Drawings - Markups/Halftone

## 2D Tools

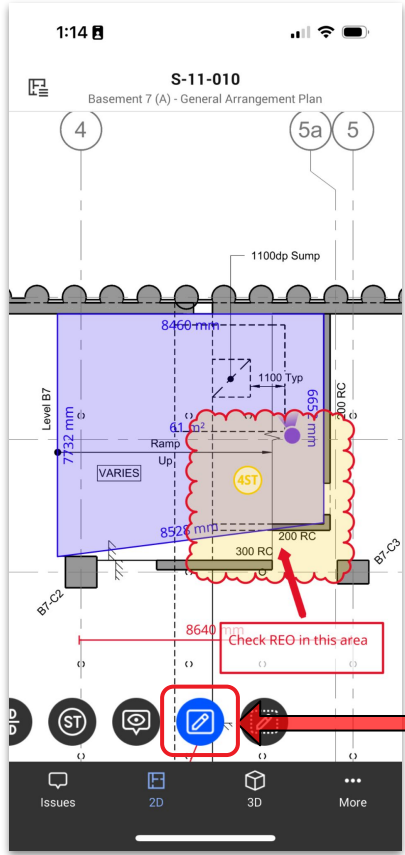
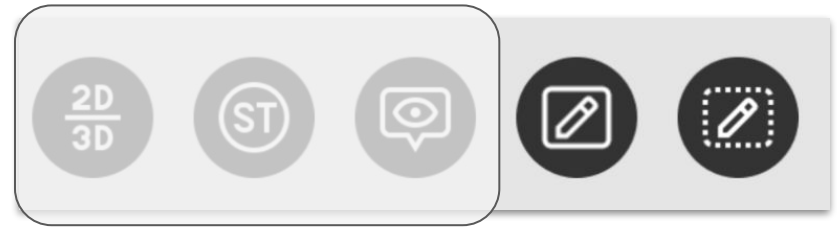

Markups On/Off

Markups

Halftone

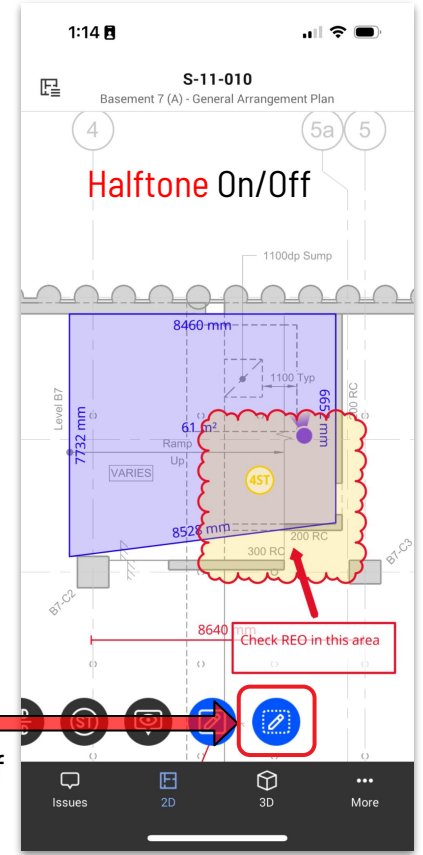

Halftone On/Off

Halftone On/Off

# 2D Drawings - Sheet **Overlay** on 3D

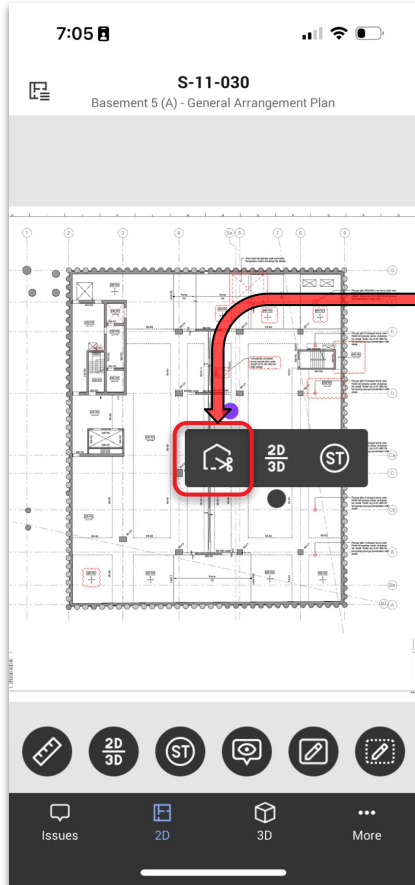

Click on sheet and select cut to **overlay** sheet on 3D model

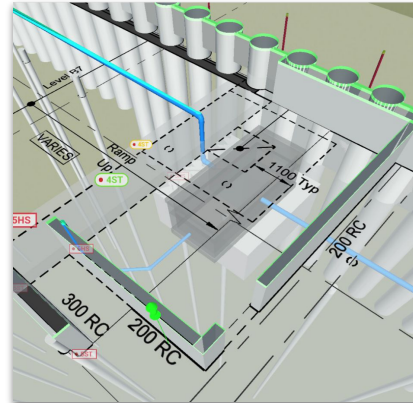

Drag model through sheet by selecting tool and **push/pull**

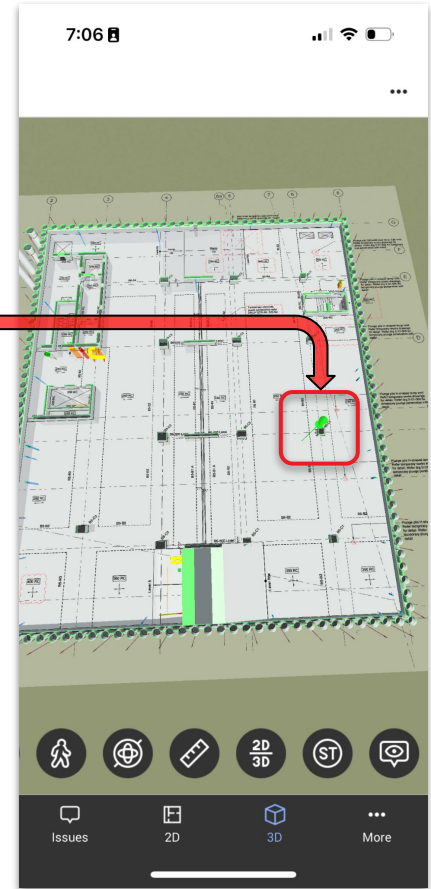

**Revizto Site**

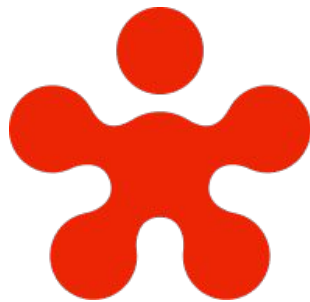

**You Tube**